

Yale EC800 Digital Leverset

USER MANUAL

All dimensions in millimetres

5 Advanced Function

5.1 Passage Mode turn on (Door without locking)

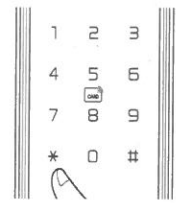
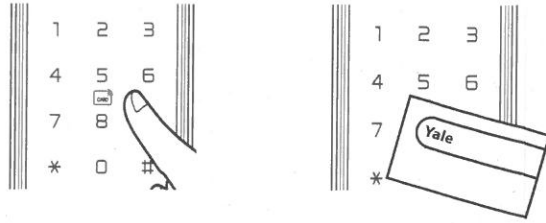

- Press PIN code or swipe KeyCard, then press “*” within 8 seconds.

(A long “beep” sounds will be heard and unlock indicator will be light on when keypad start if the lock in passage mode.)

5.2 Passage Mode turn off

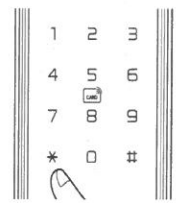

- Press “*” when the passage mode has been turn on.

(A long “beep” sounds will be heard and unlock indicator will be light off if the lock exit passage mode.)

5.3 High Security Mode turn on

(Open the Door by both PIN Code and KeyCard)

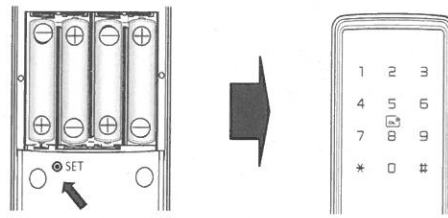

- Press and release “SET” button three times. (keypad lights will flash red and blue.)
- Then press “#” . (A long “beep” sound will be heard if the lock is in high security mode.)

5.4 High Security Mode turn off

- Press and release “SET” button three times. (keypad lights will flash red and blue.)
- Then press “*” . (A long “beep” sound will be heard if the lock exit high security mode.)

5.5 Adjustable auto locking time

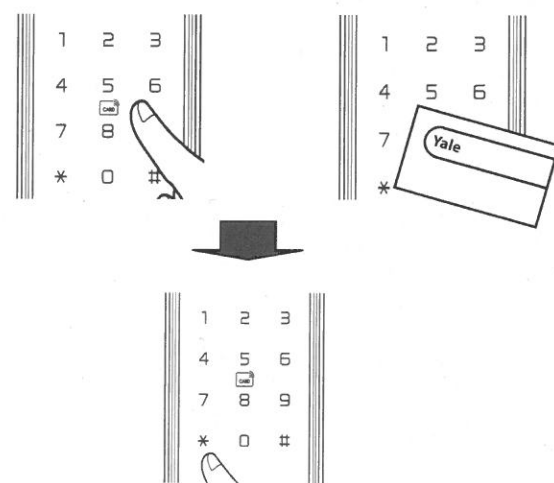

- By default automatically lock the door after 8 seconds.
- Press PIN code or swipe KeyCard, then press “8888 # 5~60 #” within 8 seconds.

(A long “beep” sounds will be heard if adjust the closing time successfully.)

6 Built In Function

6.1 Low battery alarm

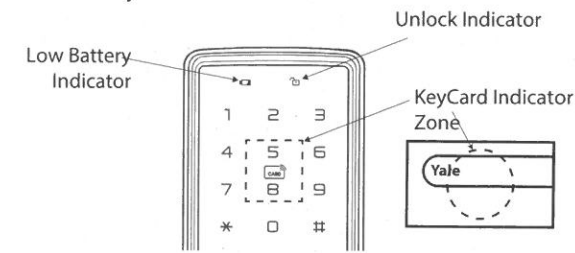

- The low battery indicator light on (red flash) when batteries almost run out.
- Need to change new batteries.

6.2 Unlock Indicator

- The unlock indicator light on (green) when allow to open door by lever.

6.3 KeyCard Induction Zone

- Best position for detecting KeyCard.

6.6 Key Operation

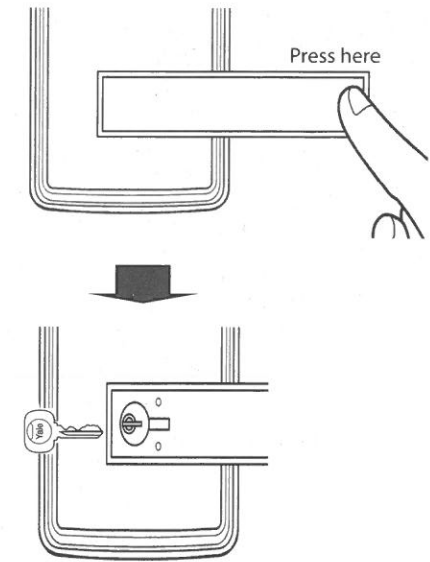

- Press end of the lever to open cover for unlock the door by key (even batteries run out).

6.4 Power shortage

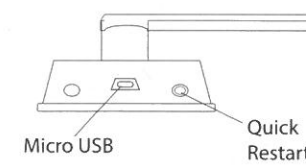

- In the case of insufficient battery, the lock can be powered by USB port located under the panel of lock.

6.5 No response

- Press “Quick Restart” button if the lock is unresponsive.

Note: PIN Code & KeyCard remained unchange.

7 Specifications

- **KeyCard Memory:**
100 KeyCards
- **PIN Code:**
6 ~ 10 numerical digits
- **Card Readable Distance:**
10mm below
- **Battery:**
4 x AAA alkaline batteries
- **Low Battery Alarm Effect:**
4.8V below
- **Static Consumption:**
40uA below
- **Dynamic Consumption:**
300mA below
- **Operation Temperature:**
-25C ~ +50C
- **Storage Temperature:**
-40C ~ +55C
- **Relative Humidity:**
10% ~ 90%
- **Automatically locking**
5~60s adjustable range (default 8s)

Yale EC800 Digital Leverset

USER MANUAL

All dimensions in millimetres

1 Before Installation

1.1 Components

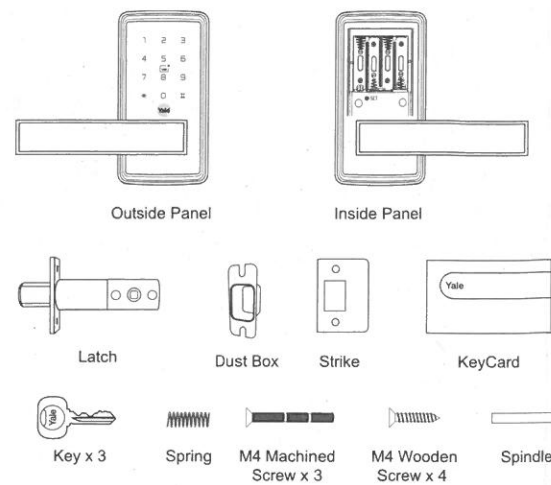

1.2 Preparation

Door Preparation

- 54mm hole saw
- 25mm hole saw
- Chisel and hammer

Fixing

- Screwdriver
- Drill
- Alkaline Batteries (AAA x 4)

2 Start Up

2.1 Register User PIN Code

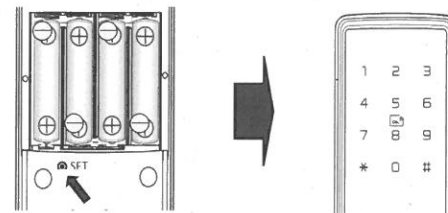

- Press and release **"SET"** button once. (The keypad light will turn blue and flash, if the lock is in setting mode.)

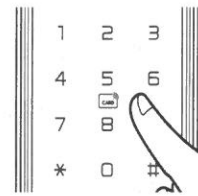

- Enter a new PIN Code (6 to 10 digits) and press **"#"** . (A long "beep" sound will be heard, if the registered successfully.)

Note: The lock will exit the setting mode after 8 seconds if no operation or press **"*"** to exit the setting mode.

3 Modification

3.1 Delete a KeyCard

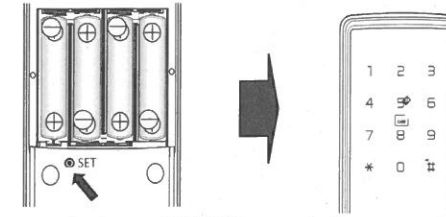

- Press and release **"SET"** button twice. (The keypad light will turn red and flash, if the lock is in deleting mode.)

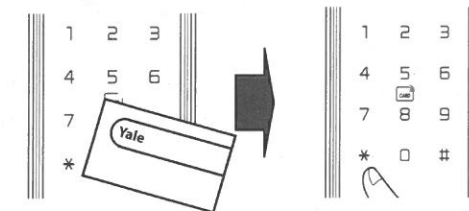

- Swipe the KeyCard on keypad induction zone. (A long "beep" sound will be heard, if the deleting successfully.)

Three short "beep" sounds will be heard if the KeyCard has no data for delete.

Note: The lock will exit the setting mode after 8 seconds if no operation or press **"*"** to exit the setting mode.

4 Usage

4.1 Open Door by PIN Code

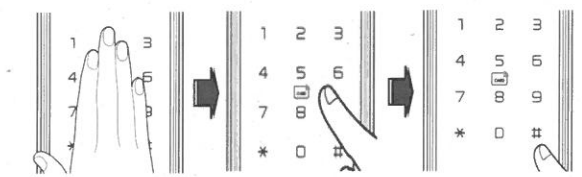

- Touch the keypad. Enter 6~16 digits (PIN code and fake PIN code) and press **"#"** to confirm. The confirmation sound will be heard if the PIN code is correct. Then turn lever to open the door within 8 seconds. After that, The confirmation sound will be heard again and door will be locked. (Fake PIN code can input before and after the PIN code.)

- If the PIN code was not correct. The keypad light will become red and flash with three short "beep" sounds. (PIN code and KeyCard for 5 consecutive errors, the system will be locked for 1 minute, and the keypad light will become red and fresh.)

1.3 Factory Reset

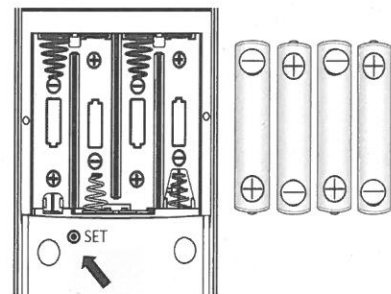

- Hold the **"SET"** button firstly and put batteries in until four "beeps" sound heard (within 5 second), then release the **"SET"** button.

The factory default PIN Code **000000** .

2.2 Register KeyCard(s)

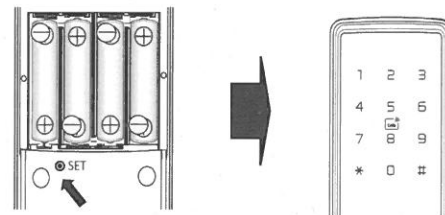

- Press and release **"SET"** button once. (The keypad light will turn blue and flash, if the lock is in setting mode.)

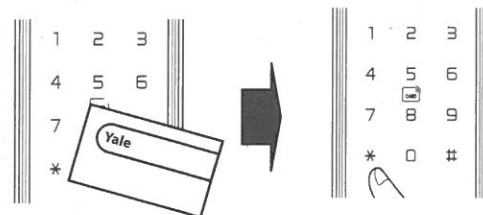

- Swipe the KeyCard on keypad induction zone. (A long "beep" sound will be heard, if the registered successfully.)

Three short "beep" sounds will be heard if the KeyCard has been registered previously with the lock.

Note: The lock will exit the setting mode after 8 seconds if no operation or press **"*"** to exit the setting mode.

3.2 Delete all the registered KeyCard(s)

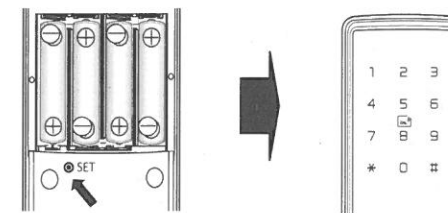

- Press and release **"SET"** button twice. (The keypad light will turn red and flash, if the lock is in deleting mode.)

- Enter **0000#**.

Note: The lock will exit the setting mode after 8 seconds if no operation or press **"*"** to exit the setting mode.

4.2 Open Door by KeyCard

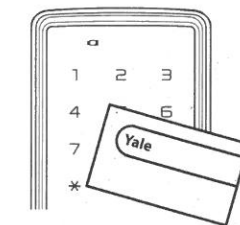

- Touch the keypad. Swipe the KeyCard on keypad induction zone. Then turn lever to open the door within 8 seconds.

(The keypad lights will become red and flash with three short "beep" sounds if the KeyCard has not been registered correctly.)