

Yale Helios S 操作说明书

材质:封面126g铜版纸,内页100g双胶纸 双面单色印刷 装订册

尺寸:205*140mm 20页

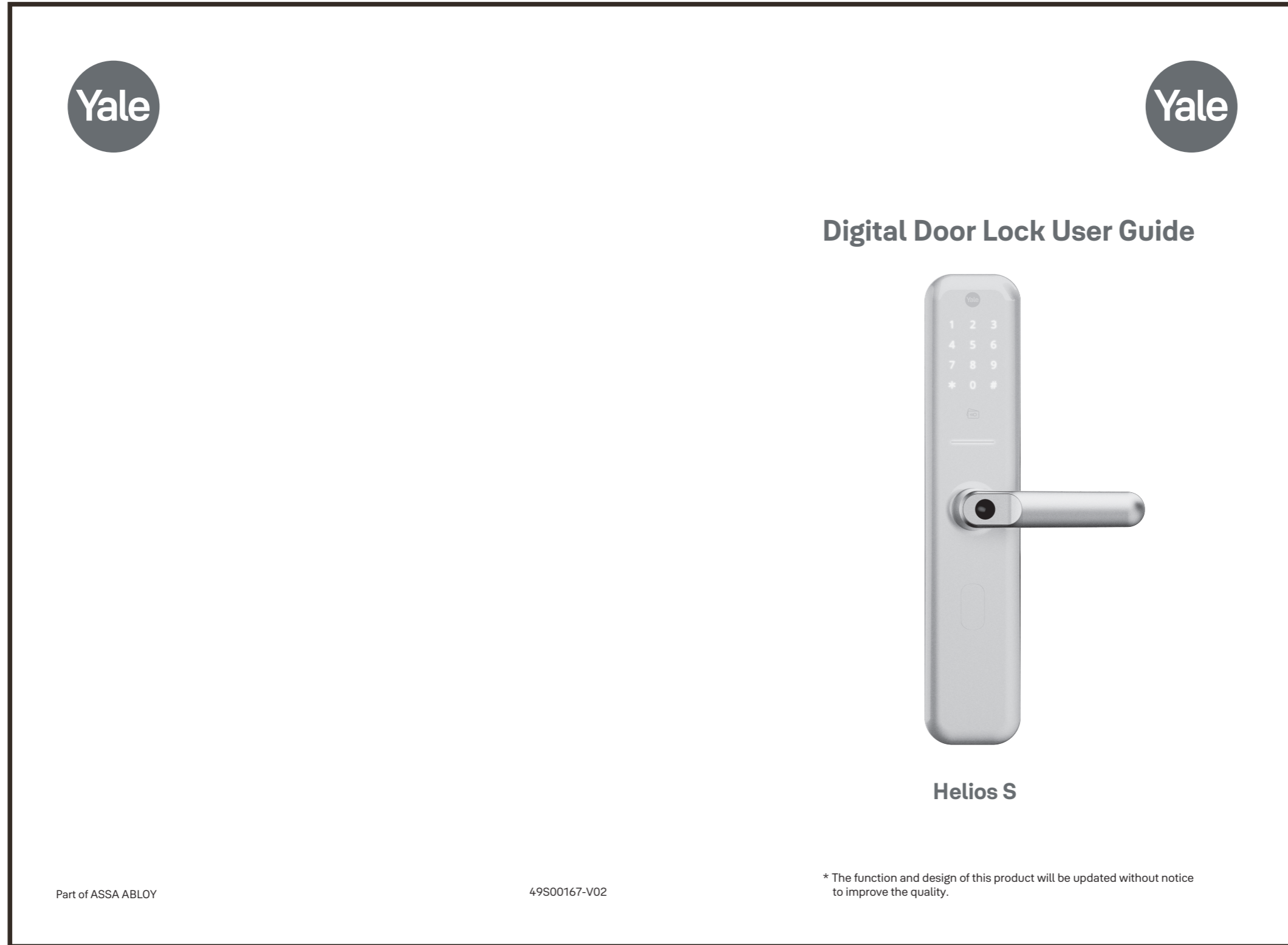

| 未注公差 | | | | | | |
|------|------|--------|----------|-----------|-------|-----|
| L | L≤6 | 6<L≤30 | 30<L≤120 | 120<L≤400 | L>400 | 角度 |
| 公差 | ±0.5 | ±0.5 | ±1.0 | ±2.0 | ±5.0 | ±0° |

技术要求:

- 1、产品的材质,刀模裁切位,以签样为准;
- 2、产品表面无明显脏污,印刷不良不全,印刷模糊,重影,黑点,无明显毛边,变形,褪色等缺陷;
- 3、未标注公差请参照左上角公差表;
- 4、未标注尺寸请按图纸备注,所标尺寸为外尺寸;
- 5、符合RoHS要求;

| | | | | | | | | | |
|------------|------------|------------|---------------------|------------|----------------------------|-------------|------------------|---------------|--|
| V4.0 | 2021.09.09 | | 删除语音韩文选项(2处) | Terry | Material 材料 | 印刷纸 | 亚萨合莱(广州)智能科技有限公司 | | |
| V3.0 | 2021.01.13 | | 修改客服电话,调整排版,内容图标 | Terry | | | | | |
| V2.0 | 2020.10.14 | | 修改名字,目录 | Terry | Finish 表面处理 | 1:1 | Product Name | Helios S | |
| V1.0 | 2020.08.07 | | 首次发布 | Terry | | | Part Name | Helios S 操作说明 | |
| Ver. 版本 | Date 日期 | ECN. 文件 | Description 更改内容 | Sign 签名 | Weight 重量(g) | Scale 比例 | Part No. 零件编号 | 49S00167-V01 | |
| Design/设计 | | Terry | | 2020.08.07 | 3st angle Proj. 第三视角投影法 | | 第 1 页 | 共 1 页 | |
| Check/审核 | | Len, Yin | | 2020.10.14 | | | Unit/单位 | mm | |
| Appd./批准 | | Michael | | 2020.10.14 | | | | | |

Content

| | |
|---------------------------------|---------|
| 1. Product Introduction |01 |
| 1.1 Product Description |01 |
| 2. Key Guide |02 |
| 2.1 Indicator Light Description |02 |
| 2.2 Icon Description |02 |
| 2.3 Button Icon Description |03 |
| 3. Operation Settings |04 |
| 3.1 Normal Mode |04 |
| 3.2 Change Mode |06 |
| 3.3 Master Mode |07 |
| 4. Network Module (Optional) |09 |
| 4.1 Network Module Settings |09 |
| 4.2 Network Module Installation |09 |
| 5. Product Features |10 |
| 5.1 How to Open the Door |10 |
| 5.2 How to Lock the Door |11 |
| 5.3 Safe Handle Feature |12 |
| 5.4 Alarm Function |13 |
| 5.5 Emergency Power |14 |
| 5.6 Replace Battery |14 |
| 5.7 Reset Button |15 |
| 6. Safety and Warning |15 |

* The pictures in this manual are for reference only,
please refer to the actual product for details *

Product Introduction

1.1 Product Description

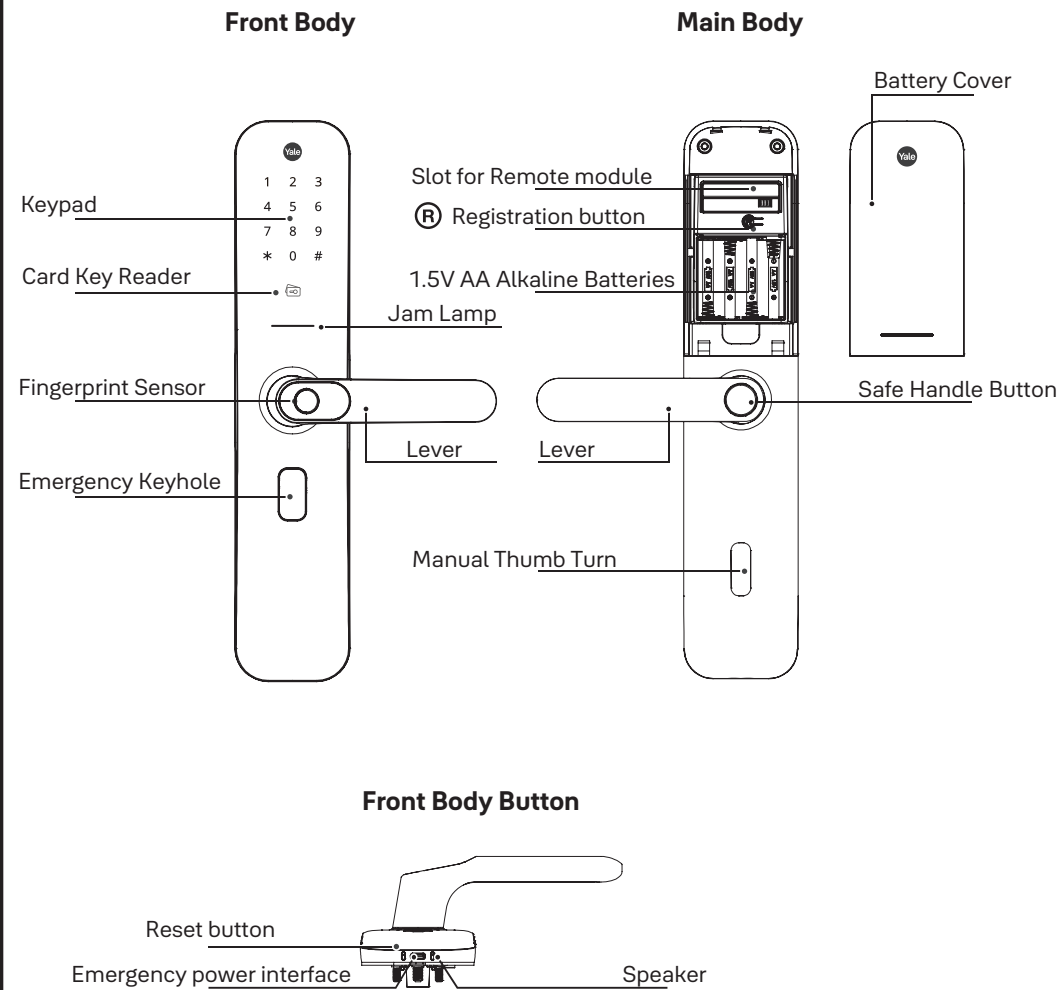

Key Guide

2.1 Indicator Light Description

Keypad indicator light, press the button, the corresponding indicator will flash; during menu operation, only the light on button is allowed to operate;







Figure:



2.2 Icon Description

| Icon | Type | Description |
|------|---------------------------|--|
| | User Code (6-10 digits) | Without a designated person, anyone who knows 'User PIN Code' has authority to set features |
| | Master Code (6-10 digits) | Only a designated person who knows 'Master PIN Code' has authority to set features |
| | Visitor Code (6 digits) | The visitor code is different from user code and given out to visitors only |
| | Onetime Code (6 digits) | The Onetime code is used only once for unlocking the door lock and automatically deleted after usage |
| | User Slot No. (2 digits) | User Slot Number should be 2 digits (like 01, 02...etc) |

2.3 Button Icon Description

| | |
|---|--|
|  | Touch the Keypad of the Front Body with your palm to begin |
|  | Press * button on the Keypad |
|  | Press # button on the Keypad |
|  | Press ® button in every steps to start or complete the session |
|  | Enter User Card Key (Up to 100EA) |
|  | Enter User Fingerprint (up to 100EA) |

Operation Settings

This product has two operating modes, normal mode and master mode. The factory default is a normal mode.

3.1 Normal Mode

User can set password like user code, visitor code, onetime code and register user's fingerprint, card keys as well.

3.1.1 Quick Menu

| Registration process | | | | | | | | | | | | * Continue / ® Complete | | | | | |
|---|---------------|----------------------|--------------|---|---------------|---|---------------|----|---|----|----|-------------------------|--|---------------------------------|--|--|--|
| | 1 | 2 | 3 | 4 | 5 | 6 | 7 | 8 | 9 | 10 | 11 | 12 | | | | | |
| User Code | | | | | | | | | | | | | | | | | |
| Registr-ation | ® | U PIN CODE New | ® | | | | | | | | | | | | | | |
| Card Key | | | | | | | | | | | | | | Up to 100EA | | | |
| Registr-ation | ® | CARD | ® | | | | | | | | | | | | | | |
| Fingerprint | | | | | | | | | | | | | | Up to 100EA | | | |
| Registr-ation | ® | * | F 8 times | * | OR | ® | | | | | | | | | | | |
| Visitor Code | | | | | | | | | | | | | | | | | |
| Registr-ation | U PIN CODE | ® | 1 | # | 1 | # | V PIN CODE | # | * | OR | ® | | | | | | |
| Delete | | | 3 | # | U PIN CODE | # | * | OR | ® | | | | | | | | |
| Onetime Code | | | | | | | | | | | | | | Automatically deleted after use | | | |
| Registr-ation | U PIN CODE | ® | 2 | # | 1 | # | O PIN CODE | # | * | OR | ® | | | | | | |
| Delete | | | 3 | # | U PIN CODE | # | * | OR | ® | | | | | | | | |
| Delete all credentials (Fingerprint) | | | | | | | | | | | | | | | | | |
| Delete all fingerprint | U PIN CODE | ® | 3 | # | 1 | # | U PIN CODE | # | * | OR | ® | | | | | | |

| Delete all credentials (Card Key) | | | | | | | | | | | |
|-----------------------------------|---------------|---|---|---|---|---|---------------|---|------|---|--|
| Delete all Card | U PIN CODE | Ⓜ | 3 | # | 2 | # | U PIN CODE | # | * OR | Ⓜ | |

⚠ Notice

- If a new user password is registered, the old user password will be automatically deleted;
- If a new card key is registered, all old cards key record will be deleted automatically;
- To register cards key in batches, just press the Ⓜ key and then register in sequence, up to 100 cards key can be registered;

3.1.2. System Setting (Normal Mode)

| Registration process | * Continue / Ⓜ Complete | | | | | | | | | | | |
|------------------------------|-------------------------|---|---|---|---|---|---|---------|------|------|----|----|
| | 1 | 2 | 3 | 4 | 5 | 6 | 7 | 8 | 9 | 10 | 11 | 12 |
| Automatic Lock | | | | | | | | | | | | |
| Enable | U PIN CODE | Ⓜ | 4 | # | 2 | # | 1 | # | * OR | Ⓜ | | |
| Disable | | | | | | | 3 | # | * OR | Ⓜ | | |
| Volume Setting | | | | | | | | | | | | |
| High Volume | | | | | | | 1 | # | * OR | Ⓜ | | |
| Low Volume | U PIN CODE | Ⓜ | 4 | # | 3 | # | 2 | # | * OR | Ⓜ | | |
| Mute | | | | | | | 3 | # | * OR | Ⓜ | | |
| Language Change | | | | | | | | | | | | |
| Registration | U PIN CODE | Ⓜ | 4 | # | 5 | # | 2 | Chinese | # | * OR | Ⓜ | |
| | | | | | | | 3 | English | # | * OR | Ⓜ | |
| Key Intrusion Warning | | | | | | | | | | | | |
| Enable | U PIN CODE | Ⓜ | 4 | # | 7 | # | 1 | # | * OR | Ⓜ | | |
| Disable | | | | | | | 3 | # | * OR | Ⓜ | | |

Automatic Lock

The factory default of the product is "Enable" to automatic lock (automatically lock and open), and the door is in a non-access door state.

① "Disable" Automatic Lock

After the operation, the automatic lock is turned off. After the first authentication and unlocking, the door is in the access door state. You can directly press the outdoor handle to open the door without authentication. After the second authentication and unlocking, the door is in a non-access door state. The above two phenomena repeat the cycle, and the cycle can be exited through the automatic lock operation of "Enable".

② "Enable" Automatic Lock

After the operation, the automatic lock is turned on. This door is in the non-access door state. After authentication is required, press the outdoor handle to open the door.

3.2 Change Mode

| Registration process | * Continue / Ⓜ Complete | | | | | | | | | | | |
|----------------------------------|-------------------------|---|---|---|---|---|----------------------|---|------------------------|----|----|----|
| | 1 | 2 | 3 | 4 | 5 | 6 | 7 | 8 | 9 | 10 | 11 | 12 |
| Normal Mode → Master Mode | | | | | | | | | | | | |
| Registration | U PIN CODE | Ⓜ | 4 | # | 1 | # | M PIN CODE New | # | M PIN CODE Again | Ⓜ | | |
| Master Mode → Normal Mode | | | | | | | | | | | | |
| Registration | M PIN CODE | Ⓜ | 6 | # | 1 | # | U PIN CODE New | # | U PIN CODE Again | Ⓜ | | |

⚠ Notice

- If you change the mode, all previously registered user information: fingerprint, password, card key will be automatically deleted.

3.3 Master Mode

Master mode is a mode in which only the administrator can set the door lock and provide access to other users. 100 users password, 100 user card key, 100 users fingerprint and individual registration and deletion of one-time passwords enable efficient management of visitors

3.3.1 Add Users and Delete Users

| Registration process | | | | | | | | | | | | | | * Continue / (R) Complete | | |
|--|---|-----|---|---|-----|---|-------|-----|----|-----|----|-----|----|---------------------------|--|--|
| | 1 | 2 | 3 | 4 | 5 | 6 | 7 | 8 | 9 | 10 | 11 | 12 | 13 | 14 | | |
| Master Pin Code Change | | | | | | | | | | | | | | | | |
| Registration | M | (R) | 1 | # | M | # | M | # | * | (R) | | | | | | |
| | | | | | New | | Again | | | | | | | | | |
| User Code UN 00~99 | | | | | | | | | | | | | | | | |
| Registration | M | (R) | 2 | # | 1 | # | UN | # | U | # | * | (R) | | | | |
| Delete | | | | | 3 | # | UN | # | * | (R) | | | | | | |
| Fingerprint Up to 100 Users | | | | | | | | | | | | | | | | |
| Registration | M | (R) | 3 | # | 1 | # | UN | # | F | # | * | (R) | | | | |
| Delete | | | | | 3 | # | UN | # | * | (R) | | | | | | |
| Card Key Up to 100 Users | | | | | | | | | | | | | | | | |
| Registration | M | (R) | 3 | # | 2 | # | 1 | # | UN | # | C | # | * | (R) | | |
| Delete | | | | | 3 | # | UN | # | * | (R) | | | | | | |
| One time Code Only 1 User, Automatically deleted after use | | | | | | | | | | | | | | | | |
| Registration | M | (R) | 4 | # | 1 | # | 0 | # | * | (R) | | | | | | |
| Delete | | | | | 3 | # | M | # | * | (R) | | | | | | |
| Delete all credentials (Fingerprint, Card Key) | | | | | | | | | | | | | | | | |
| Delete | M | (R) | 5 | # | M | # | * | (R) | | | | | | | | |

3.3.2 System Setting (Master Mode)

| Registration process | | | | | | | | | | | | * Continue / (R) Complete | | |
|-----------------------|---|-----|---|---|---|---|---|---|---------|----|-----|---------------------------|--|--|
| | 1 | 2 | 3 | 4 | 5 | 6 | 7 | 8 | 9 | 10 | 11 | 12 | | |
| Automatic Lock | | | | | | | | | | | | | | |
| Enable | | | | | | | | 1 | # | * | (R) | | | |
| Disable | M | (R) | 6 | # | 2 | # | | 3 | # | * | (R) | | | |
| Volume Setting | | | | | | | | | | | | | | |
| High Volume | | | | | | | | 1 | # | * | (R) | | | |
| Low Volume | M | (R) | 6 | # | 3 | # | | 2 | # | * | (R) | | | |
| Mute | | | | | | | | 3 | # | * | (R) | | | |
| Language Change | | | | | | | | | | | | | | |
| Registration | M | (R) | 6 | # | 5 | # | | 2 | Chinese | # | * | (R) | | |
| | | | | | | | | 3 | English | # | * | (R) | | |
| Key Intrusion Warning | | | | | | | | | | | | | | |
| Enable | | | | | | | | 1 | # | * | (R) | | | |
| Disable | M | (R) | 6 | # | 7 | # | | 3 | # | * | (R) | | | |

※ Network Module (Optional)

4.1 Network Module Settings

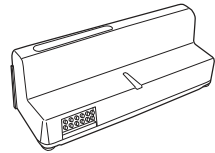

This product can use a variety of functions through simple settings; confirm the model of the product currently in use before upgrading the function. Before installing the network module, please set to the master mode.

4.2 Network Module Installation

- ① Open the battery cover on main body and remove all batteries;
- ② Install the module in the module slot;
- ③ Reinstall the battery: Pay attention to the positive and negative directions.

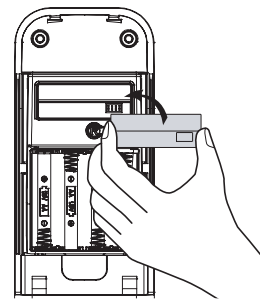

After install the network module, the registration process as below:

| Registration process | | ※ Continue / (R) Complete | | | | | | | | | | | |
|-----------------------------|---------------|---------------------------|---|---|---|---|---|---|---|---|----|----|----|
| | | 1 | 2 | 3 | 4 | 5 | 6 | 7 | 8 | 9 | 10 | 11 | 12 |
| Network module Registration | | | | | | | | | | | | | |
| Registration | M PIN CODE | (R) | 7 | # | | | | | | | | | |

⚠ Notice

- After install the network module, when the smart lock pair or unpaired with the mobile App, all previously registered user information (except the administrator password): fingerprints, passwords, and cards key will be automatically deleted.
- After the smart lock is connected to the Internet, all operations such as user management and system settings can only be performed in the mobile app.

Product Function

5.1 How to Open the Door

5.1.1 Use Fingerprint, Pin Code, Card Key to Unlock

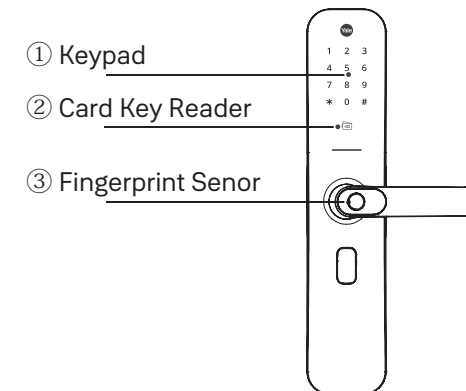

- ① Touch the key area with your palm, wake up the key, enter the added password, and press [X] to confirm.
- ② Put the registered door card in the door card identification area.
- ③ Put the registered finger on the fingerprint reader.

⚠ Notice

- In normal mode, Security enhancement to enter any number before or after entering a password to prevent the PIN code from being exposed.
- In master mode, Fake PIN Code function is not supported.

5.1.2 Mechanical Key Unlock

In the event of an emergency, such as forgetting the password, running out of battery power, or unoperability of the system, you can use a spare mechanical key to unlock the door.

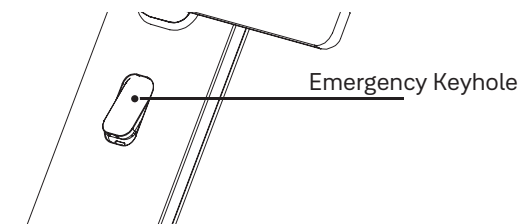

5.1.3 Unlock the Door with Silent Mode

Activate the silent mode, unlock the door when using PIN code, fingerprint, cards key with silent

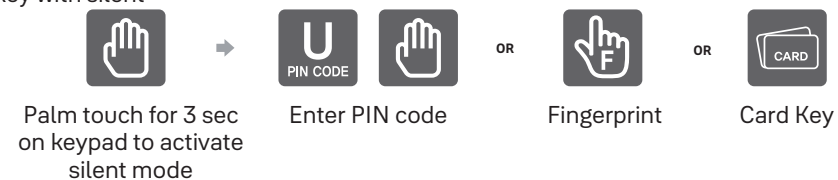

5.2 How to Lock the Door

5.2.1 Lock the Door from Outside

Door closed, lifted up the outdoor handle, the latch bolt and multipoint bolt will be locked

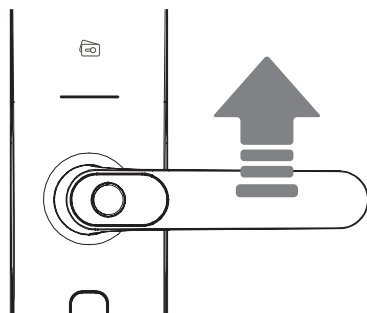

5.2.2 Lock the Door from Inside

Keep pushing the safe handle button, lifted up the indoor handle, the latch bolt and multipoint bolt will be locked

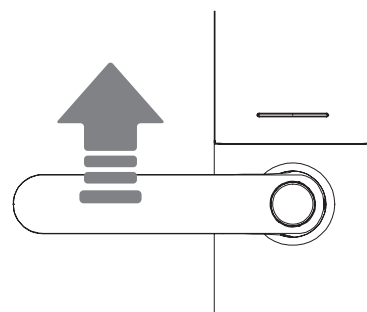

5.2.3 Indoor Lock

Use Thumb turn knob to manual lock from inside, it cannot unlock from outdoor, and it needs to unlock form inside.

5.3 Safe Handle Feature

The criminals use a special tools to open the lock by press down indoor handle. When going out, turn on the safe handle function to lock the indoor handle and prevent the handle from being pressed down to open the door.

5.3.1 Unlock from Inside with Safe Handle

- ① Keep pushing the safe handle button, And then,
- ② Press the handle down up open the door

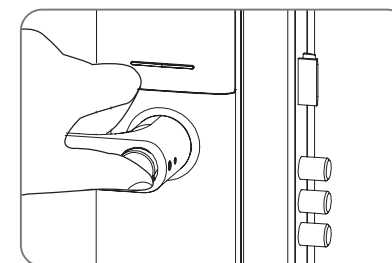

5.3.2 Disable Safe Handle Setting

Default Safe handle function is in the set state.

- ① Keep pushing the safe handle button
- ② Turn the fixing screw clockwise to fix the button

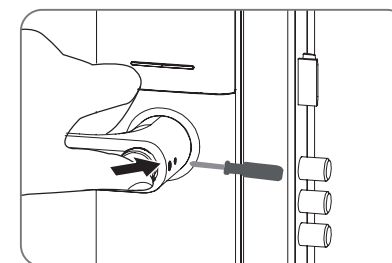

5.3.3 Enable Safe Handle Setting

Turn the fixing screw anticlockwise until the safe handle button comes out.

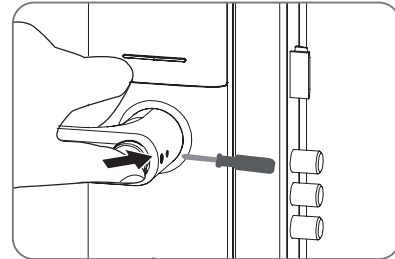

Notice

- Press the indoor handle down couldn't open the door if you have not keep pressing the safe handle button
- It is easy to cause damage to the indoor handle if the indoor handle is pressed down forcefully without pressing the safe handle button .

5.4 Alarm

5.4.1 Low Power Indicated

When the battery power is too low, the low battery LED on keypad flickers red, and play the low battery notification message when you unlock the door

5.4.2 Broken Alarm

The alarm sounds when the front part is completely separated from the main set. To release:

- ① Enter the registered User PIN code
- ② Touch the registered card key

5.4.3 Intrusion Alarm

The alarm goes off when someone force the door open. To release:

- ① Enter the registered User PIN code
- ② Touch the registered card key

Notice

- Alarm sound is about 80db, and it will released after 3 minutes.

5.4.4 3-minute Lock Out Feature

If an invalid user code, fingerprint or card key is entered five (5) times in a row, lock out mode is activated and all button on the front body are not activated for three minutes.

5.5 Emergency Power Supply

External emergency power supply (5V) can be used to connect the USB (Type-C) interface to start the system for discharged batteries.

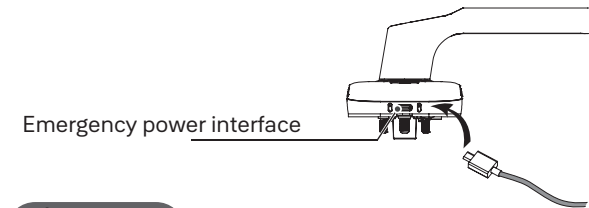

Emergency power interface

Notice

- The emergency power supply is only used for emergency unlocking, and it is not recommended to use it frequently;
- The emergency power supply of this product is the 5V power supply of the USB (Type-C) interface.

5.6 Replace Battery

5.6.1 Battery Life

The product uses four 1.5V Alkaline AA batteries. They may sustain 1 year if used 10 times a day.

5.6.2 Low Power Indicated

Replace all 4 batteries when low battery notification message is played.

5.6.3 Replace Method

- ① Open the battery cover on main body and remove all batteries;
- ② Reinstall the battery: Pay attention to the positive and negative directions;
- ③ Reinstall the battery cover.

5.7 Reset Button

When the system fails, press the reset button to restore the system to normal.

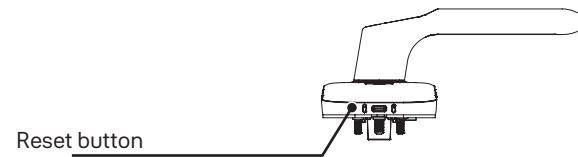

Safety and Warning

- ① Do not install the digital door lock in an outdoor environment.
- ② Do not use water and any type of solvent to clean the product such as gasoline or benzene as they can cause damage to electronic circuit, deterioration and or paint peel-off.
- ③ Do not use rechargeable batteries. Only alkaline batteries are recommended and prefer to replace it every 10 months.
- ④ Replace all batteries when low battery notification message is played.
- ⑤ If the multipoint or dead bolt is inflexible or unable to lock the door normally due to the deformation of the door, please adjust the position of the door plate at this time.
- ⑥ Do not use force to close the door when multipoint or dead bolt pops out.
- ⑦ Please keep the mechanical key at least one in a safe place other than your home for emergency.
- ⑧ Please use the 5V power supply to connect the USB (Type-C) interface when run out the battery.