

K13F



人面識別 快而準

特點 Features

- ◆  Face Recognition
20人面識別
 - ◆  Fingerprint
100指紋
 - ◆  PIN Code
11組密碼
 - ◆  Card
可配對
100咭
 - ◆  Mechanical Key
跟機2支匙
- ◆ 室內感應解鎖
Indoor Sensor Unlock, Fast and Safe
 - ◆ 雙重認證
Double Verification
 - ◆ Micro USB緊急電源
Micro USB backup charge
 - ◆ 防止入侵警報功能
Break In / Break Out Alarm



溫馨提示

- 此產品不適用於露天/半戶外/戶外/商用使用。此產品不包括防水功能。
- CRG對產品之任何周邊損壞或因操作而引致之任何週邊損失或損毀，概不負責
- 請勿在鎖運作時拆電池。
- 注意保養條款，詳情可參閱保養証。
- 品牌如有更新規格或設置，將不另行通知。

Kind Reminder

- This product is NOT for Outdoor or Semi-Outdoor or commercial use.
- CRG shall NOT be responsible or liable for any damage or loss resulting from the operation or performance of any Product in which a Product is incorporated.
- Please DO NOT replace the battery while the lock is operating.
- Brand may change specification without prior notice.

本鎖的系統模式分為常用模式和安全模式，出廠默認系統模式為常用模式。

There is normal mode and safety mode, factory default at Normal Mode.

安全模式：需要雙重驗證（人臉+指紋、人臉+卡片、人臉+密碼、卡片+密碼、指紋+密碼、卡片+指紋）
如用此模式，必需已登記任何2組指紋或咭或密碼。

Safety mode: Double Verification to unlock (e.g. Face+Fingerprint / Face+Card / Fingerprint+PIN etc)

* Enable this mode, at least any 2 of Fingerprint / Card / PIN has been registered.

常用模式：單重驗證（人臉、密碼、指紋、卡片都可驗證）

Normal mode: Single Verification to unlock (Face/Fingerprint/PIN/Card)



***無法正常運作時，請用筆尖按一下鎖底部重新啟動按鍵**

***Press Reset Button at the bottom of the lock by pin while the lock malfunction.**

室外 安裝於室外

Outdoor



室內 安裝於室內

Indoor



常用模式 Normal Mode (出廠默認 Default)

登記管理者密碼 Setting Master PIN (首次)

 觸控面板 * * 12345678 # 管理者密碼 # 管理者密碼 #
Press the Number Pad Master Pin Master Pin

更改管理者密碼 Change Master PIN 6-12位數字密碼不包括* 或#
PIN= 6-12 numbers exclude symbol

 觸控面板 * * 管理者密碼 # 1 9 新管理者密碼 # 新管理者密碼 #
Press the Number Pad Master Pin New Master Pin New Master Pin

登記用戶人面 Setting Face ID (最多Up to 20)

 觸控面板 * * 管理者密碼 # 1 1 用戶編號 #
Press the Number Pad Master Pin User ID No (00-19)



站立約一臂60 cm 距離
Stand around arm length distance

刪除個別用戶人面 Delete Individual Face ID

 觸控面板 * * 管理者密碼 # 1 5 1   或 OR 用戶編號 #
Press the Number Pad Master Pin User ID No (00-19)



刪除全部用戶人面 Delete All Face ID

 觸控面板 * * 管理者密碼 # 1 5 2

登記用戶密碼 Setting User PIN (最多Up to 10) 6-12位數字密碼不包括* 或#
PIN= 6-12 numbers exclude symbol

 觸控面板 * * 管理者密碼 # 1 2 用戶編號 #  # 
Press the Number Pad Master Pin User ID No (00-09)

刪除個別用戶密碼 Delete Individual PIN

 觸控面板 * * 管理者密碼 # 1 6 1   或 OR 用戶編號 #
Press the Number Pad Master Pin User ID No (00-09)

刪除全部用戶密碼 Delete All PIN

 觸控面板 * * 管理者密碼 # 1 6 2

****用戶密碼有虛位密碼功能 (防偷窺) 密碼最長為32位
虛位密碼 + 用戶密碼 + # (開門) / 用戶密碼 + 虛位密碼 + # (開門)**

常用模式 Normal Mode (出廠默認 Default)

登記用戶指紋 Setting User Fingerprint (最多Up to 100)

 觸控面板 * * 管理者密碼 # 1 3 用戶編號 # 
Press the Number Pad Master Pin User ID No (00-99)

刪記個別用指紋 Delete Individual User Fingerprint

 觸控面板 * * 管理者密碼 # 1 7 1  或  用戶編號 #
Press the Number Pad Master Pin User ID No (00-99)



刪記全部用戶指紋 Delete All User Fingerprint

 觸控面板 * * 管理者密碼 # 1 7 2
Press the Number Pad Master Pin

登記用戶咭 Setting User Card (最多Up to 100)

 觸控面板 * * 管理者密碼 # 1 4 用戶編號 # 
Press the Number Pad Master Pin User ID No (00-99)

刪記個別用戶咭 Delete Individual User Card

 觸控面板 * * 管理者密碼 # 1 8 1  或  用戶編號 #
Press the Number Pad Master Pin User ID No (00-99)

刪記全部用戶咭 Delete All User Card

 觸控面板 * * 管理者密碼 # 1 8 2
Press the Number Pad Master Pin

轉換安全模式 Change to safety mode (Double Verification)

 觸控面板 * * 管理者密碼 # 5 2
Press the Number Pad Master Pin

必需已登記任何2組 指紋或咭或密碼。
Enable this mode at least any 2 of
Fingerprint / Card / PIN has been registered.

轉換常用模式 Change to normal mode (出廠默認 Default)

 觸控面板 * * 管理者密碼 # 5 1
Press the Number Pad Master Pin

任何一個已登記指紋或咭或密碼可解鎖。
Under this mode at least any registered
Fingerprint / Card / PIN can unlock.

設定節能模式 Setting Power Save Mode

觸控面板 * * 管理者密碼 # 6 1
Press the Number Pad Master Pin

人面不能使用
Face ID cannot be used

取消節能模式 Cancel Power Save Mode (出廠默認 Default)

觸控面板 * * 管理者密碼 # 6 2
Press the Number Pad Master Pin

設定自動上鎖模式 Enable Auto Mode (出廠默認 Default)

觸控面板 * * 管理者密碼 # 7 1
Press the Number Pad Master Pin

關門自動上鎖
Lock while door is closed

取消自動上鎖模式 Disable Auto Mode

觸控面板 * * 管理者密碼 # 7 2
Press the Number Pad Master Pin

關門不會上鎖
Will not lock while door is closed

設定旅行模式 Activate Travel Mode

觸控面板 * * 管理者密碼 # 7 2
Press the Number Pad Master Pin



如設置了，室內解鎖開門會有警報。
從室外解鎖一次便取消了此模式
Once activate the travel mode,
unlock from indoor will have
alarm. Once unlocked from
outdoor will disable this mode.

設置語音 Setting Voice (出廠默認有語音 Default Setting with voice mode)

觸控面板 * * 管理者密碼 # 2 1
Press the Number Pad Master Pin

1 有語音
Voice Mode

2 靜音
Silent Mode

雖然設置靜音，但仍有
警報及語音操作指引
While Set Silent
mode, alarm and
setting voice guide
still active.

設置語言 Setting Language (出廠默認國語 Default Putonghua)

觸控面板 * * 管理者密碼 # 2 2
Press the Number Pad Master Pin

1 華語 Chinese (Putonghua)

2 英語 English

系統查詢 System Inquiry (Serial Number)

 觸控面板 * * 管理者密碼 # 3 1
 Press the Number Pad Master Pin

反鎖設置 Internal force lock mode

長按下室內 Close 鍵 3秒
 Press and Hold Indoor Close Button 3 second



如啟動了反鎖，只有室內解鎖或室外輸入管理者密碼 # 才可解鎖
 Once activated this mode, only unlock from indoor or input Master PIN # can deactivate this

回復出廠設置 Back to factory setting

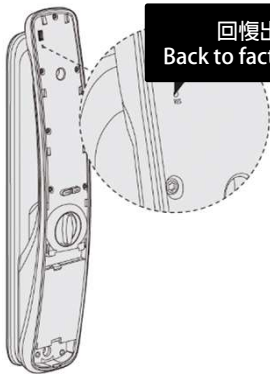

回復出廠鍵
Back to factory Button

從頂部 打開上蓋
 Put Off the Cover from the top

按2下回復出廠鍵
 Double Click back to factory button

回復出廠後管理者密碼
 Master Pin will become 12345678

如不慎遺忘管理者密碼，可打開電池蓋，在通電狀態下，雙擊回復出廠設置鍵，會有語音提示已恢復出廠設置
 You can resume factory setting if you have forgotten the master PIN. Double click the "Back to factory Button", lock will have successfully voice notification.

室外解鎖 Unlock from Outdoor



已登記人面
Registered Face

推或拉門
Pull or push the door



輸入已登記密碼 #
 Enter Registered PIN #

推或拉門
Pull or push the door



已登記指紋
Registered Fingerprint

推或拉門
Pull or push the door



已登記咭
Registered Card

推或拉門
Pull or push the door

鎖的底部 Bottom view



緊急備用匙
Emergency Key

將機械匙插入轉動 180度再推或拉門
 Put the key into the key hole, turn 180 and the Pull or push the door

室內解鎖 Unlock from Indoor



當手遮擋感應器，鎖會自動解鎖，然後用戶自行拉或推門

While the sensor is covered by your hand, will unlock automatically and pull or push the handle to open the door

解鎖感應器
Unlock Sensor

手動將手擰轉往上轉至12點方向，然後用戶自行拉或推門

Turn the Lock open turn to unlock position as below shown, and pull or push the handle to open the door

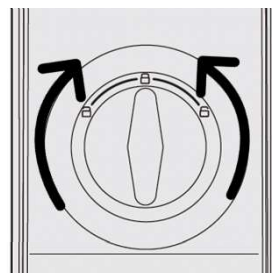

按下 OPEN 鍵，然後用戶自行拉或推門

Press the Open button, and pull or push the handle to open the door

開鎖
Open Button



安裝步驟 Installation Step

1. 定好方向 Determine left or Right open

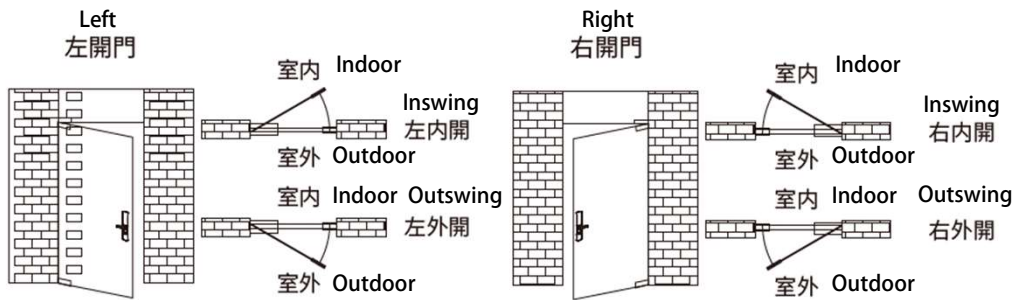

2. 調好鎖舌 Adjust the latch to your case

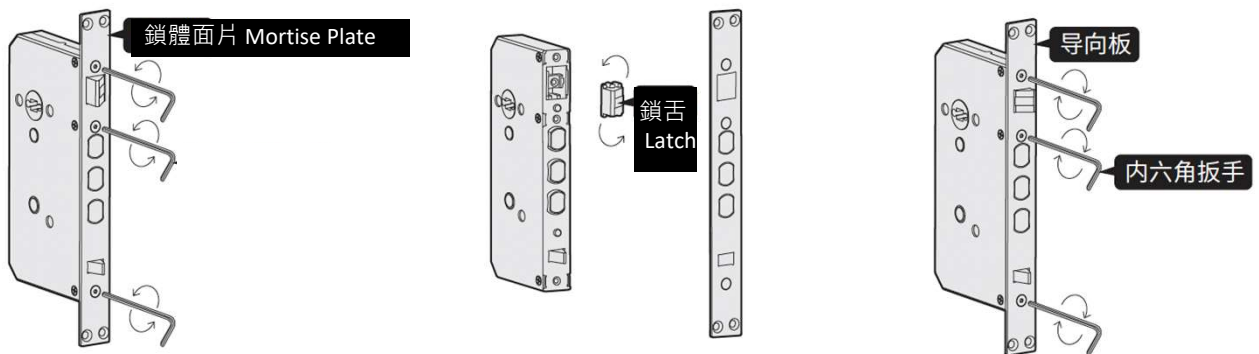

3. 固定鎖體及安裝室外鎖 Tighten the lockcase and install the exterior lock

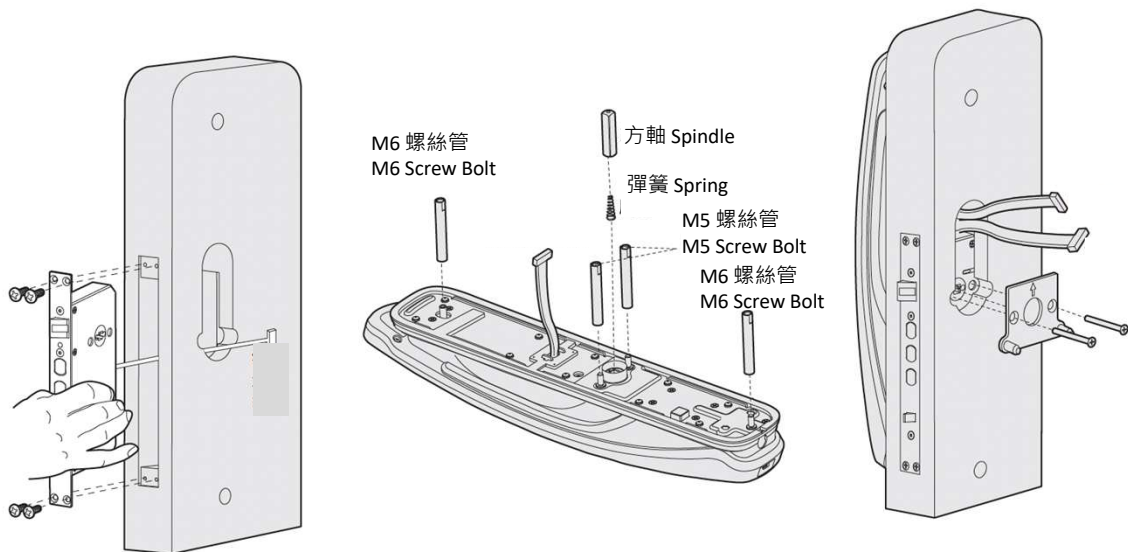

**請先選好合適門厚之相關螺絲配件
Please pick the proper parts length
as per the door thickness**

安裝步驟 Installation Step

4. 安裝室內鎖 Install the interior lock

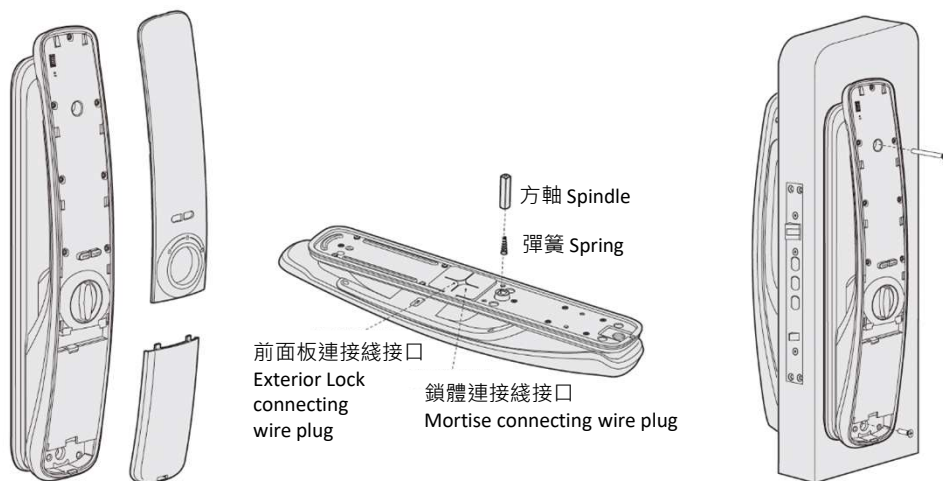

5. 放入電池及放回電池蓋 Insert Battery into battery compartment and close the battery cover

