

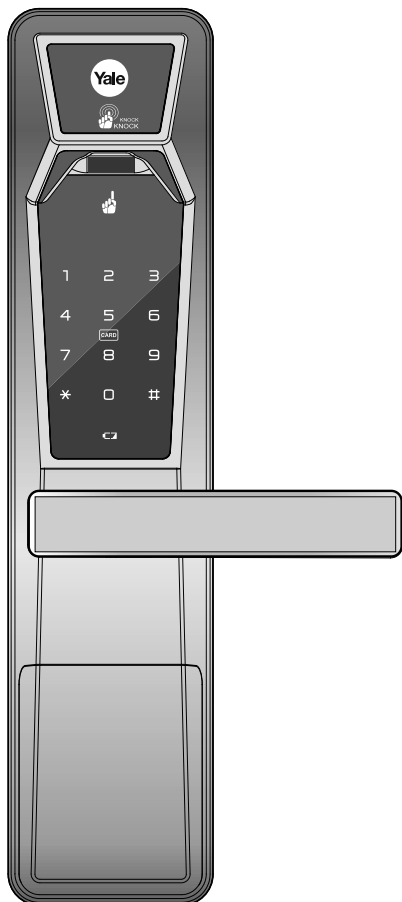

User Guide

YDM4111 / YDM7111



※ The functions and design of this product can be changed without prior notice for quality improvement.
※ Chinese manual is from 33 page. (中文说明书从第33页)

Introduction

For peace of mind, you need to secure yourself, your home and your personal belongings. Yale Digital Door Locks take care of all of this so that you can enjoy your life without any worries. In these products we have combined our long experience in making secure and reliable locks with the latest technology for convenience and safety.

With all the functions for convenience and safety, Yale Digital Door Locks clearly offer you more than just security. In addition to this, we have also put a lot of effort in the aesthetic design of these products, so that your Yale Digital Door lock can actually enhance the appearance of your door while securing it at the same time.

The future of locking is already here and ready for use. Get rid of all your concerns regarding the security of your home and use a Yale Digital Door Lock to unlock the door to the potential of your life.

Unlock your life!

<http://www.yaledigital.com.cn> (CHINA)
<http://www.yalelock.com> (APEC & EMEA)

The world's favorite lock



Contents

Getting Started

Safety Precautions	4
Product Features	5
Quick Guide	6

Directions

Components Overview	10
Identification	11
How to Use	12

- Master PIN Code
- User PIN Code
- Fingerprint Guide
- Normal Mode: Using Fingerprint
- Security Mode: Using Fingerprint
- Removing Fingerprint
- Card Key (For Only YDM7111)
- Lock Door
- Opening Door from Inside

Settings	22
----------------	----

- Safe Handle • Volume Setting • Fingerprint Mode
- Auto Locking • Passage Mode • Forced Lock
- Voice and Melody • Language
- Alert setting on mechanical override key use

Safety Feature	28
----------------------	----

- Alarm Feature • 3-minute Lock Feature
- Open Door with Dicoy PIN Code
- Emergency mechanical key override

Extra Features

Optional Accessory	30
--------------------------	----

- Remote Control Module
- Remote Control

Emergency Power	32
-----------------------	----

- Emergency Power Supply for discharged Batteries

Product Specification	62
-----------------------------	----

Safety Precautions

Please Read This Carefully

Do not install the product in an outdoor environment.

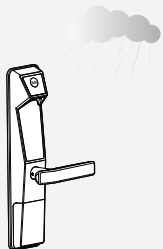

Do not attempt to disassemble the unit by yourself. That can cause an electronic shock and product damage.

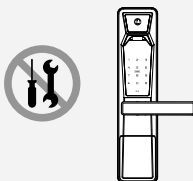

Do not spray water directly to the product or wipe it with chemical substances such as benzene, thinner, or alcohol when cleaning the product.



Do not force with a tool.

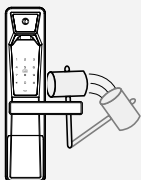

Be careful not to let any unauthorized users discover your PIN Code. Please keep your PIN Code safe.



Make sure the door is locked when leaving Home.

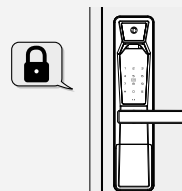

Be careful not to hit the handle as it may cause injuries.

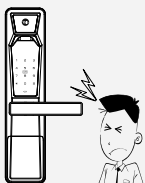

Keep foreign materials away from the fingerprint sensor to maintain it cleanly and do not use it with wet fingers.



Caution

Make sure to follow the above instructions to avoid any injuries or damages on the properties .

Product Features

1 Easy Fingerprint Scan

Patent

Easy Scan technology has been applied to conveniently read a fingerprint in one shot without the need to open or close the cover to enter a fingerprint.

2 Smart Pad Feature

Patent

A separate lighting method where each keypad number has been separately designed is applied so that users may examine intuitively how the selected function is operated and if they are run normally.

3 SHM(Safe Handle Mechanism) Technology

Patent

SHM(Safe Handle Mechanism) Technology that makes it impossible to open the Doorlock to trespass a house by drilling a hole on the entrance or through a pet door has been applied.

4 Palm Touch Feature

Patent

To prevent the User PIN Code from being exposed due to residual cardkeys after opening a door, a new technology has been adopted to complete the door opening process by touching the keypad with a palm after entering the User PIN Code.

5 Tri-Directional Deadbolt

Tri-directional deadbolt toward the door frame and upward, downward offers extra security and peace in mind.

6 Remote Control System (optional)

Patent

You may use a remote control by installing the Remote Control Module. It enables you to link it with the Network package – a wireless security system.

Quick Guide

1 Registering User PIN Code

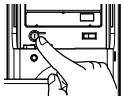

Press **1** (Registration) button

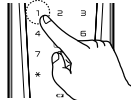

Enter numbers **1** Twice

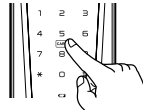

Enter user PIN Code (6 to 12 digits)

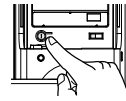

Press **1** (Registration) button

2 Registering Master PIN Code

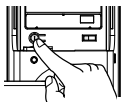

Press **1** (Registration) button

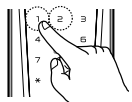

Enter numbers **1** and **2**

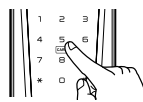

1 Enter the registered Master PIN Code

2 Enter **#**

3 Enter new Master PIN Code (6 digits)

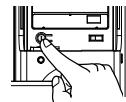

Press **1** (Registration) button

3 Fingerprint Normal Mode Setting

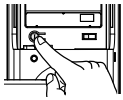

Press **1** (Registration) button

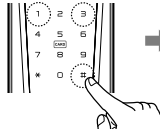

Enter numbers **#**, **1** and **3**

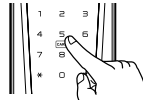

Enter the Master PIN Code (6 digits)

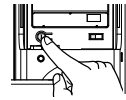

Press **1** (Registration) button

4 Fingerprint Security Mode Setting

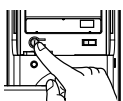

Press **1** (Registration) button

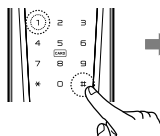

Enter numbers **#**, **1** twice

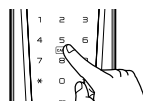

Enter the Master PIN Code (6 digits)

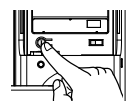

Press **1** (Registration) button

Quick Guide

5 Registering Fingerprints (Normal Mode)

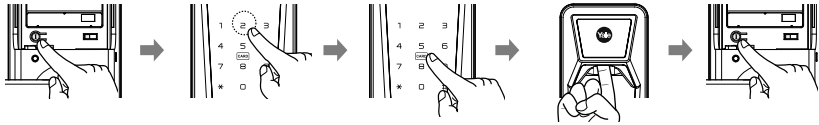

Press **1** (Registration) button

Enter number **2**

- 1** Enter the Master PIN Code
- 2** Enter **#**

Sweep your finger(fingerprint) through the fingerprint sensor 3 times to register

Press **1** (Registration) button

6 Registering Fingerprint (Security Mode)

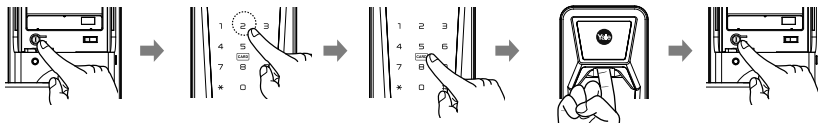

Press **1** (Registration) button

Enter number **2**

- 1** Enter the Master Number
- 2** Enter **#**
- 3** Enter fingerprint number

Sweep your finger(fingerprint) through the fingerprint sensor 3 times to register

Press **1** (Registration) button

7 Registering Card Key (For Only YDM7111)

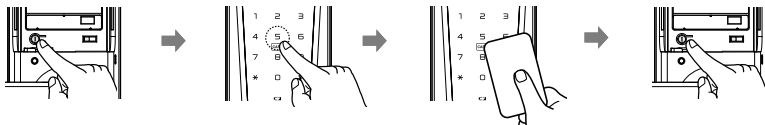

Press **1** (Registration) button

Enter number **5**

Contact **all the keys** you wish to register on one by one

Press **1** (Registration) button

Important

- The default Master PIN Code is '1 2 3 4 5 6'.
- The default User PIN Code is '1 2 3 4 5 6 7 8 9 0'.

Quick Guide

7 Locking the Door from the outside

Lift up outer handle after Closing the door to lock the door securely.



Locking
with the handle

8 Unlocking the Door from the outside

- ① Sweep your Fingerprint on Fingerprint sensor, or
- ② Wake up the lock with the palm touch, enter the User PIN Code and retouch the lock with the palm,
- ③ Press the outer handle down to open the door.



Opening
with the handle

9 Locking / Unlocking the Door from the inside.

Push the safe handle button and operate the handle to lock or open.



Locking
with the handle



Opening
with the handle

10 Emergency mechanical override key

Please operate the lock with the mechanical override key when you have a Problem with locking or opening, for example:

- Forgotten User PIN Code
- Electronic malfunction

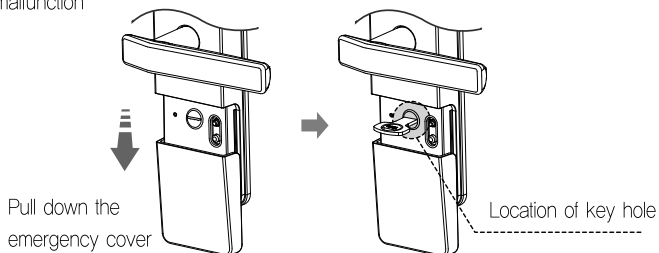

Directions

Components Overview	10
Identification	11
How to Use	12
Master PIN Code	
User PIN Code	
Fingerprint Guide	
Normal Mode: Using Fingerprint	
Security Mode: Using Fingerprint	
Removing Fingerprint	
Card Key (For Only YDM7111)	
Locking Door	
Opening Door from Inside	
Settings	22
Safe Handle • Volume Setting • Fingerprint Mode	
Auto Locking • Passage Mode • Forced Lock	
Voice and Melody • Language	
Alert setting on mechanical override key use	
Safety Feature	28
Alarm Feature • 3-minute Lock Feature	
Open Door with Dicoy PIN Code	
Emergency mechanical key override	

Extra Features

Optional Accessory	30
Remote Control Module	
Remote Control	
Emergency Power	32
Emergency Power Supply for discharged Batteries	

Components Overview

Basic Contents

The contents of this product may be subject to change without notice for performance or quality improvement.

➤ Basic Contents

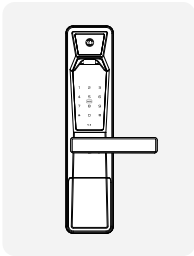

Front Body

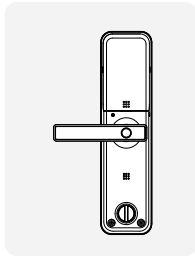

Back Body

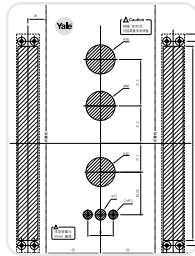

Installation Template

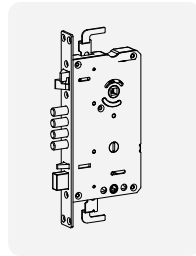

Lock case

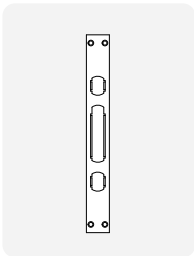

Strike Plate



User Guide

- 4 Batteries
- 2 Mechanical override keys
- Bolt
- 4 Card Keys (For Only YDM7111)
- Front Shaft

➤ Optional Accessory (purchase separately)

- Remote control
- Remote control module

Identification

Front Body

(Front Body, install on the outside of the door)

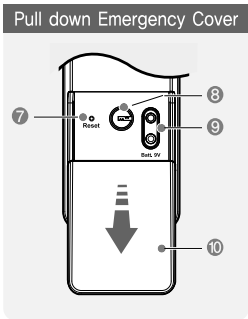
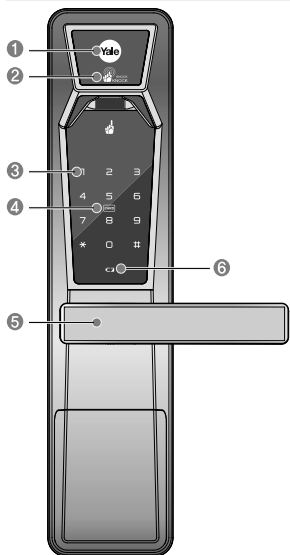

9V Emergency battery (Optional)

1	Fingerprint Wake up sensor
2	Fingerprint sensor
3	Keypad (10-Key)
4	Card Key Reader (For Only YDM7111)
5	Outer Handle
6	Low battery Indicator
7	Reset button
8	Location of key hole
9	Emergency Power Supply Terminal
10	Emergency Cover

Back Body

(Back Body, install on the inside of the door)

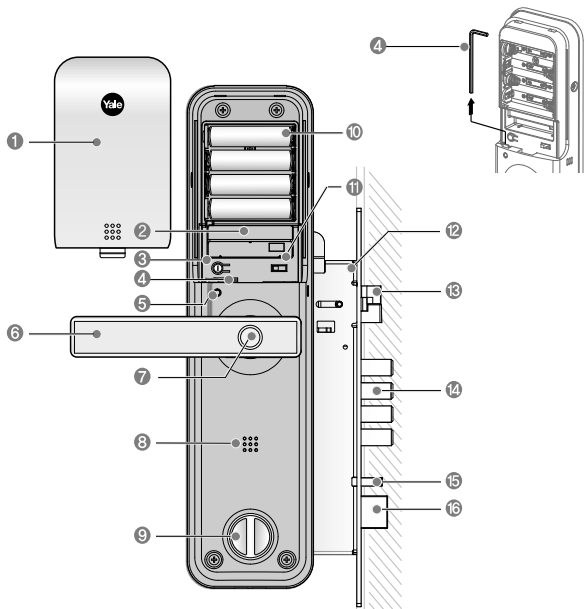







1	Battery Cover
2	Slot for Remote Control module(Optional extra)
3	① Registration button
4	Hex wrench
5	Passage Indicator
6	Inner Handle
7	Safe handle button
8	Speaker
9	Internal Forced Lock knob
10	1.5V AA Alkaline Batteries
11	Volume Control Switch
12	Lock case
13	Latch Bolt
14	Dead Bolt
15	Edge Bolt
16	Inner Forced Lock Bolt

How to Use

To Use Master PIN Code

> To Register Master PIN Code

Step	Icon	Description
1 Press Ⓜ (Registration) button		Open the battery cover in the Back Body and press Ⓜ (Registration) button once.
2 Enter numbers 1 and 2		Enter numbers 1 and 2 according to the voice guide.
3 Enter the registered Master PIN Code		Enter the registered Master PIN Code (6 digits) according to the voice guide. (The default Master PIN Code is '1 2 3 4 5 6')
4 Enter #		Enter #
5 Enter a new Master Number to register		Enter a Master PIN Code (6 digits) to register according to the voice guide.
6 Press Ⓜ (Registration) button		Press the Ⓜ (Registration) button in the Back Body again to complete the Master PIN Code registration.

To use Master PIN Code



- The Master PIN Code is required to register or remove a fingerprint.
- If you forget the Master PIN Code, you may not register or remove a fingerprint.

▲ Important







- The default Master PIN Code is '1 2 3 4 5 6'.
- Please be sure to remember your master code. In case of forgetting the Master Code, it can't be recovered.

How to Use

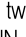

To Use User PIN Code

User PIN Code should be set within 6 to 12 digits, [*] and [#] are not allowed.

» To Register User PIN Code

Step	Icon	Description
1 Press  (Registration) button		Open the battery cover in the Back Body and press  (Registration) button once.
2 Enter numbers  twice → Enter the User PIN Code		Enter numbers 1 twice and then enter the User PIN Code on the keypad according to the voice guide. (6 to 12 digits)
3 Press  (Registration) button		Press the  (Registration) button in the Back Body again to complete the User PIN Code registration.

» To Open Door with User PIN Code

Step	Icon	Description
1 Touch with palm		Touch the keypad of the Front Body gently with your palm.
2 Enter User PIN Code		Enter the registered User PIN Code on the keypad.
3 Touch with palm		Touch the keypad of the Front Body gently with your palm or enter [*] button to end.

Note

- Make sure to leave the door open when registering a User PIN Code because you may accidentally lock a door while trying to register or change a User PIN Code the first time.
- The previously registered User PIN Code will automatically be deleted when the new User PIN Code is registered.
- When registering a User PIN Code, the registered User PIN Code will be displayed on the keypad.

How to Use

Fingerprint

➤ Fingerprint Guide

To change modes: Please refer to page 23.

Normal Mode : It enables you to make separate registration, and open a door through the registered fingerprint or User PIN Code.

Security Mode : It enables you to make separate registration and deletion, and open a door only when the fingerprint number and the fingerprint are matched.

Repeated Operations



⚠ Important





- You may register up to 20 fingerprints. (The same applies to Normal/Security Mode)
 - ※ Note that you may not be able to register up to 20 fingerprints depending on the previously registered fingerprints data size.
- Scan-type fingerprint modules do not recognize fingerprints with water or foreign substances and error sound is heard.
- Make sure to register a User PIN Code for the case that you fail to register a fingerprint.
- Make sure to leave the door open when registering a User PIN Code because you may accidentally lock a door while trying to register or change a User PIN Code.
- If an error occurs during registration, the process reverts back the beginning (entering fingerprint).
- If no more input is made for 20 seconds after registering at least 1 fingerprint, the registration will be complete.
- Duplicate fingerprints may be registered.
- Same fingerprints can be registered repeatedly.

How to Use



Normal Mode: Use Fingerprint

It enables you to make separate registration, and open a door through the registered fingerprint or User PIN Code.

» To Register Fingerprint

Step	Icon	Description
1 Press I (Registration) button		Open the battery cover in the Back Body and press I (Registration) button once.
2 Enter numbers 2 ➔ Enter the Master PIN Code ➔ Enter #		Enter numbers 2 according to the voice guide. Enter the Master PIN Code and then [#] on the keypad.
3 Register fingerprint - 3 times		After the operation lamp is lit, sweep your fingerprint 3 times through the fingerprint sensor according to the voice guide.
4 Press I (Registration) button		Press the I (Registration) button in the Back Body again to complete the fingerprint registration. (Enter [#] to continue the fingerprint registration process.)

» To Open Door with Fingerprint

Step	Icon	Description
1 Touch the Yale logo		Touch the Yale for wake up.
2 Enter fingerprint		After the operation lamp is lit, sweep the registered fingerprint through the fingerprint sensor in the Front Body .

Check if a door opens!







Make sure to examine if the door opens normally with the registered User PIN Code or fingerprint after the registration is complete.

How to Use

Security Mode: Use Fingerprint



It enables you to make separate registration and deletion, and open a door only when the fingerprint number and the fingerprints are matched.

» To Register Fingerprint

Step	Icon	Description
1 Press ① (Registration) button		Open the battery cover in the Back Body and press ① (Registration) button once.
2 Enter number 2 ➔ Enter the Master PIN Code ➔ Enter #		Enter the number 2 according to the voice guide. Enter the Master PIN Code and then the [#] on the keypad.
3 Enter fingerprint number		Enter 4-digit fingerprint number to register.
4 Register fingerprint – 3 times		After the operation lamp is lit, sweep your fingerprint 3 times through the fingerprint sensor according to the voice guide
5 Press ① (Registration) button		Press the ① (Registration) button in the Back Body again to complete the fingerprint registration. (Enter [#] to continue the fingerprint registration process.)

Repeat this process for other users. E.g. Family members.



» To Open Door with Fingerprint

Step	Icon	Description
1 Touch with palm		Touch the keypad of the Front Body gently with your palm.
2 Enter fingerprint number		Enter the registered fingerprint number in the keypad.
3 Enter fingerprint		Sweep the registered fingerprint through the Front Body fingerprint sensor.





How to Use

Remove Fingerprint

» To Delete All Fingerprints (Normal and Security mode)

Step	Icon	Description
1 Press I (Registration) button		Open the battery cover in the Back Body and press I (Registration) button once.
2 Enter number 3 → Enter the Master PIN Code		Enter the number 3 according to the voice guide and then, enter the Master PIN Code on the keypad.
3 Press I (Registration) button		Press the I (Registration) button in the Back Body again to delete all fingerprints.









» To Delete Each Fingerprint (Security mode)

Step	Icon	Description
1 Press I (Registration) button		Open the battery cover in the Back Body and press I (Registration) button once.
2 Enter number 4 → Enter the Master PIN Code → Enter #		Enter the number 4 according to the voice guide and then, the Master PIN Code and [#] on the keypad.
3 Registered fingerprint number		Enter the fingerprint number to delete on the keypad.
4 Press I (Registration) button		Press the I (Registration) button in the Back Body again to delete fingerprints individually.

How to Use

To Use Card Key (For Only YDM7111)

» To Register Card Key (For Only YDM7111)

Step	Icon	Description
1 Press  (Registration) button		Open the battery cover in the Back Body and press  (Registration) button once.
2 Enter number 		Enter the number 5.
3 Contact all the Card Keys you wish to register on the [Card Key reader] one by one		If you hear a "plk" sound, the Card Keys are registered. If you hear a "ti-to-ti-to" sound, the Card Key had been already registered.
4 Press  (Registration) button		Press the  (Registration) button in the Back Body again to delete fingerprints individually.

How to Use

» To Open Door with Card Key (For Only YDM7111)

Step	Icon	Description
Contact Card Key		Contact Card Key

Check if the door opens!



Make sure to examine if the door opens normally with the registered User PIN Code after the registration is complete.

Note

- Keep the door open while you register Card Key to prevent yourself from accidentally getting locked out.
- The previously registered Card Key will automatically be deleted when the new Card Key is registered.
- When registering the Card Keys, Keypad displays the number of registered Card Keys.

How to Use

Lock Door

» To Close Door from Outside

Step	Icon	Description
Flip lift up the handle	 OUTSIDE	To lock the door securely, lift outer handle up after the door was closed.

- ※ After 1 minute, the outer handle will disengage automatically to lock the door with latch bolt only.
- ※ Please lift the outer handle up to secure dead-locking when you go out.

» To Close Door from Inside

Step	Icon	Description
Flip lift up the handle	 INSIDE	To securely lock your door from the inside, lift up the handle. You can securely lock your door at anytime.

Caution

- If the handles are not lifted to securely lock your door, the door is held on the latch only. Please make sure to lock your door securely with lifting the handle up before you leave.

How to Use

Open Door from Inside

The default setting is Safe Handle Setting.

» To Open Door when the safe handle button is released.

Keep pushing the safe handle button. And then, press and push to open the door. The safe handle button is found on the inner handle.

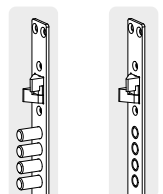
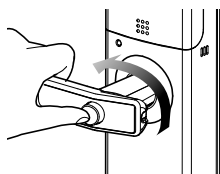

(Closed) (Open)

» To Open Door when the safe handle button is fixed.

Press and push the inner handle to open the door.

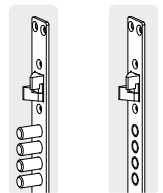
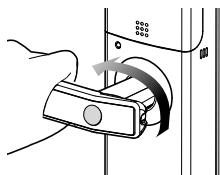

(Closed) (Open)

▲ Important

- Make sure to fully familiarize yourself with the operations for the Safe Handle in preparation for emergencies.

Settings

Safe Handle Feature

The technology to prevent a forced attempt to drill a hole in the door and unlock the Doorlock has been applied.

» To Release Safe Handle Setting (Default setting)

Hex wrench location:
Please refer to Page.11

- 1 Open the battery cover and take out a hex wrench.
- 2 Keep pushing the safe handle button, Turn the fixing screw clockwise to fix the button.

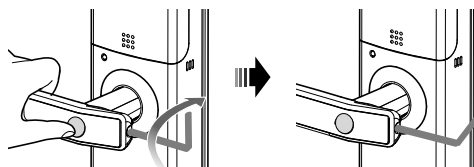

» To Set Safe Handle

Hex wrench location:
Please refer to Page.11

- 1 Open the battery cover and take out a hex wrench.
- 2 Turn the fixing screw anticlockwise until the safe handle button released

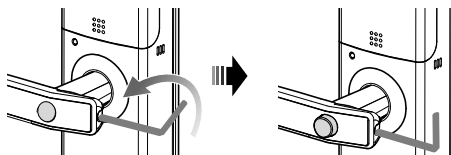

Volume Setting Feature

It enables you adjust the sound volume.

The default setting is High.

» Volume Setting (Default setting)

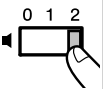
Step	Icon	Description
To adjust the sound volume		The operation sound volume will be adjusted according to the Volume Switch Setting. (2 : High / 1: Low / 0 : Mute)

Note









- Be careful that the fixing screw not to be separated during the safe handle setting.
- Even when the operation sound is set to 'Mute', the error and alarm will sound.

Settings

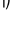
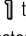
Change to Fingerprint Mode

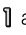
The default setting is Normal Mode.

» Fingerprint Mode Setting

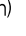
Step	Icon	Description
1 Press  (Registration) button and #		Open the battery cover in the Back Body. Press  (Registration) button and then [#]
Security Mode Setting Enter numbers  twice → Enter the Master PIN Code		Enter numbers 1 twice on the keypad. Enter the registered Master PIN Code.
Normal Mode Setting Enter numbers  and  → Enter the Master PIN Code		Enter numbers 1 and then 3 again on the keypad. Enter the registered Master PIN Code.
2 Press  (Registration) button		Press  (Registration) button again to set Security Mode or Normal Mode.

Important

- If you change fingerprint mode, it will be deleted registered all PIN Code.
- Even after a door was locked by the Auto Lock function, please check again if the door was completely locked.
- Keep a list of User PIN numbers in a safe place to enable future deletion, when required.
- If more than 1 fingerprint is registered after the Security Mode is set, you may not open a door with a User PIN Code.
(If the fingerprint module is broken, you may use a User PIN Code.)







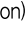

Settings

Auto Locking Mode

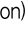
Auto lock setting locks a door in 1 minute after the door was closed.



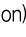

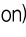

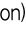

The default setting is Auto Locking mode.

» To set Auto Locking Mode

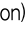
Step	Icon	Description
1 Press  (Registration) button and #		Open the battery cover in the Back Body. Press  (Registration) button and then [#].
2 Enter number  and  on the keypad		Enter number 0 and then 1 again on the keypad.
3 Press  (Registration) button		Press  (Registration) button again in the Back Body.

Passage Mode

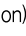
» To set Passage Mode

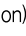
Step	Icon	Description
1 Press  (Registration) button and #		Open the battery cover in the Back Body. Press  (Registration) button and then [#].
2 Enter number  and  on the keypad		Enter number 0 and then 3 again on the keypad.
3 Press  (Registration) button		Press  (Registration) button again in the Back Body. * Check the indicator shows Red on the Back Body.

Note

- The passage mode enables you to open your door at anytime and from any side.
- The red lamp flashes every 7 second in passage mode.
- Please make sure to lock securely after using the passage mode.

Settings

Forced Lock

» Outside Forced Lock Setting – Fingerprint

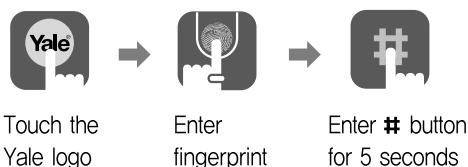

- ① Touch the Yale logo to wake up,
- ② Sweep the registered fingerprint through the fingerprint sensor in the Front Body.
- ③ Enter the [#] button for 5 seconds. (A beeping sound sets off for 3 times.)

» Outside Forced Lock Setting – User PIN Code



- ① Touch the keypad of the Front Body gently with your palm.
- ② Enter the registered User PIN Code on the keypad.
- ③ Enter the [#] button for 5 seconds. (A beeping sound sets off for 3 times.)

» Outside Forced Lock Setting – CARD (For Only YDM7111)

Step	Icon	Description
Contact Card Key		Contact the Card Key on [card key reader] for 5 seconds until you hear 3 beeps.

» Inside Forced Lock Setting

Step	Icon	Description
Set / Release inside Forced Lock knob.		When the door is closed, turn the Inside Forced Lock thumbturn to LOCK or UNLOCK position

Note



- If you open a door with the handle from inside in outside forced lock, the alarm will sound.
- If the Inside Forced Lock is set, any attempt to open a door from the outside whether it is with a fingerprint or a User PIN Code this will not work.

Settings

Voice and Melody

You may select the operation sound when a door is open and closed.



» To Set Voice and Melody

Step	Icon	Description
1 Press I (Registration) button and #		Open the battery cover in the Back Body. Press I (Registration) button and then [#]
2 Enter number 2 twice on the keypad		Enter the numbers 2 twice on the keypad.
3 Press I (Registration) button		Press I (Registration) button again in the Back Body.

Language Setting

English and Chinese languages are supported.

» To set Language

Step	Icon	Description
1 Press I (Registration) button and #		Open the battery cover in the Back Body. Press I (Registration) button and then [#].
2 Enter number 2 and 3 on the keypad		Enter the number 2 and then 3 again on the keypad.
3 Press I (Registration) button		Press I (Registration) button again in the Back Body.









Note

- This alert setting toggles between activation and deactivation of the alert setting.

Settings

Alert setting on mechanical override key use (ON/OFF)

» To Set Alert setting on mechanical override key use

Step	Icon	Description
1 Press  (Registration) button and #		Open the battery cover in the Back Body. Press  (Registration) button and then [#].
2 Enter number  and  on the keypad		Enter number 0 and then 8 again on the keypad.
3 Press  (Registration) button		Press  (Registration) button again in the Back Body.

Note

- This alert setting toggles between activation and deactivation of the alert setting.

Safety Feature

Alarm Feature

The alarm sound continues for 30 minutes or until it is reset.

» Damage Alarm

Damage: When the Front Body was damaged due to forced separation or drilling, the alarm will sound.

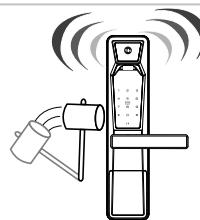

To Release Damage Alarm

Method ① Enter the registered User PIN Code.

Method ② Enter the registered fingerprint.

Method ③ Press the interior ① button for 5 seconds.

3-minute Lock Feature

At 3-minute Lock mode, no button, will work except the button inside.

» 3-minute Lock Mode Display

- If incorrect security codes or unregistered Finger print(10times) are attempted 5 times in a row, it will lock out for about 3 minutes with the blinking LED.

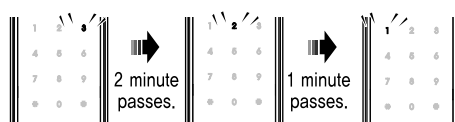

3 minute Lock starts.
The number [3]
lights up.

2 minutes left.
The number [2]
lights up.

1 minutes left.
The number [1]
lights up.

To Release 3-minute Lock

Method ① Press the ① button.

Method ② Turn the inside handle.

Note



- If the alarm sounds due to damage, the numbers on the keypad will be lit up and rotated.
(It repeats the status for 30 minutes with an alarm sound.)
- 3-minute Lock mode will not affect the alarm mode and is sustained even after the product is rebooted.

Safety Feature

Open Door with Dicoy PIN Code

It is the most effective feature when you are concerned about the User PIN Code being accidentally exposed.

» To Open Door with Dicoy PIN Code

Step	Icon	Description
1 Touch with a palm		Touch the keypad with your palm gently.
2 Enter the Dicoy PIN Code and a User PIN Code		Method 1 Enter the Dicoy numbers* → PIN Code Method 2 Enter the PIN Code → Dicoy numbers* <small>*any that you choose do not have to be the same.</small>
3 Touch with a palm		Touch the keypad with your palm gently or enter [*] to end.

Emergency mechanical key override

» Emergency mechanical key override

- Operate the lock with the mechanical key when there is a problem to the lock or unlock the door that is the same as below listed.
- Forgotten User PIN Code
- Electronic malfunction

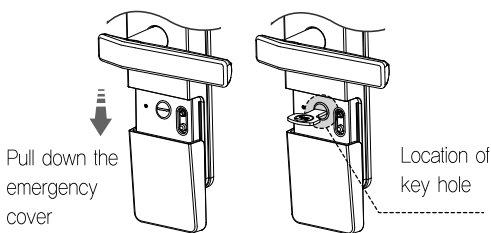

Important

- When opening the door with mechanical key, the alarm will sound. (When the setting is on activation)
- On inner forced locking, the door cannot be opened even with the mechanical key

Note

- Once 3-minute Lock mode is on, the Dicoy PIN Code mode will not work until the next normal verification (fingerprint verification, User PIN Code, open door from inside). In this case, please open a door with User PIN Code.
- Keep the mechanical override key in a safe place.
- Otherwise, you may not get a free service within during the warranty period.

Optional Accessory

Remote Control Module

Buy the Remote Control Module and install it to link the Remote Control.

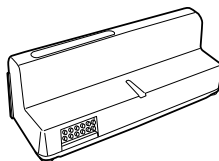

Remote Control Module

➤ Install Remote Control Module

1 Remove batteries

Open the battery cover in the Back Body and remove all batteries.

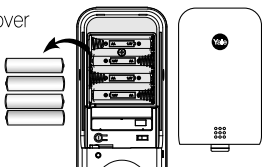

2 Install Remote Control Module

Equip the Remote Control Module to the connector.

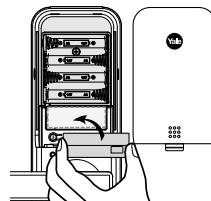

3 Insert batteries

Insert all the batteries by checking the [⊕, ⊖] connector.

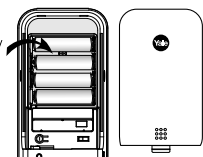

4 Confirm the installation

If you hear a 'ting-a-ling' sound, the Remote Control Module has been installed correctly. Close the battery cover.

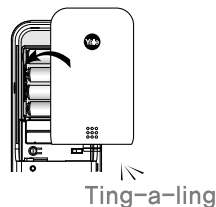

Note











- The operation status may only be examined through the Remote Control.

Optional Accessory

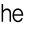







Remote Control

The wireless encryption algorithm has been applied.

» To Register Remote Control

Step	Icon	Description
1 Press  (Registration) button and #		Open the battery cover in the Back Body. Press  (Registration) button and then [#].
2 Enter number  and  on the keypad		Enter number 0 and then 5 on the keypad.
3 Register Remote Control		Press the SET button on the remote control (Up to 5 Remote controls)
4 Press  (Registration) button		Press the  (Registration) button in the Back Body again to complete the procedure.

» To Release Remote Control

Step	Icon	Description
1 Press  (Registration) button and #		Open the battery cover in the Back Body. Press  (Registration) button and then [#].
2 Enter number  and  on the keypad		Enter number 7 and then 5 again on the keypad.
3 Press  (Registration) button		Press the  (Registration) button in the Back Body again to complete the procedure.

Note





- The wireless encryption algorithm resorts to the floating ID technology where the wireless User PIN Code is changed every time the Remote Control is operated.

Emergency Power

Emergency Power Supply for Discharged Batteries

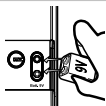
You may open a door when contacting the 9V battery.

» To Supply Emergency Power

Step	Icon	Description
1 Contact the 9V Alkaline battery		Open the emergency cover. Keep contacting the 9V Alkaline battery onto the emergency power supply terminal.
2 Touch with a palm		Touch the keypad gently with your palm.
3 Enter User PIN Code		Enter each number of User PIN Code.
4 Enter *		Enter [*] to confirm. (Once the motor is fully operated, you may detach the 9V battery.)

» To Replace Battery

1 Expiry Period

The product uses four 1.5V Alkaline AA batteries. They may sustain 1 year if used 10 times a day.
(Users are advised to use authentic alkaline batteries.)



2 Low Battery Alarm

You must replace all 4 batteries for the following cases:

- * The Low Battery Lamp on the Front Body lights on
- * The alarm melody will sound
(a nursery rhyme starting with ting-a-ling melodies)
- * The voice guide will sound ("Please replace batteries.")

Low Battery Lamp (red)

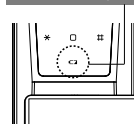

Front Body



Note

- The battery life vary depending on temperature, moisture levels, Frequency of use and the quality of the batteries.

中文简单说明书



快速使用指南

1 登记 [使用者] 密码 (新产品出厂时, 默认设定为1, 2, 3, 4, 5, 6, 7, 8, 9, 0)

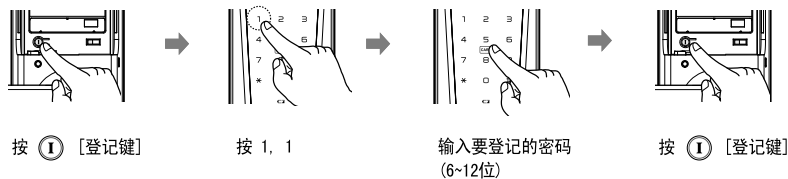

2 登记 [管理者] 密码 (新产品出厂时, 默认设定为1, 2, 3, 4, 5, 6)

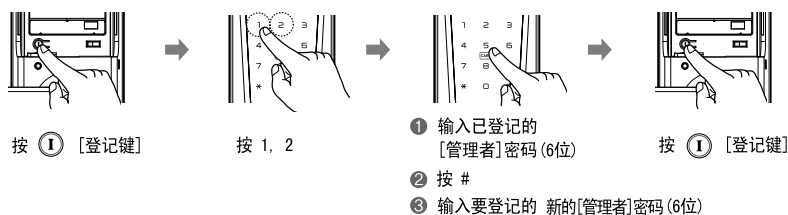

3 设置为 [一般模式] → 按 ①, #, 1, 3, [管理者] 密码, ①

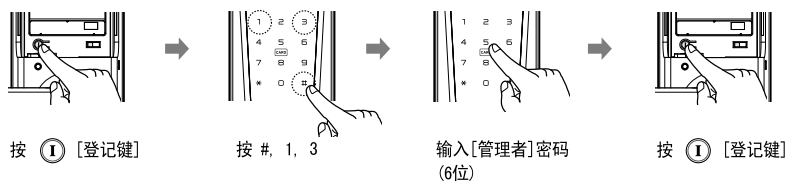

4 设置为 [保安模式] → 按 ①, #, 1, 1, [管理者] 密码, ①

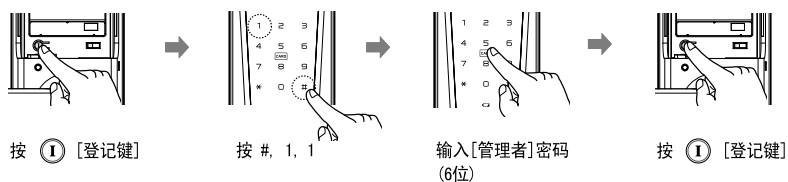

快速使用指南

开始

5 登记指纹[一般模式]

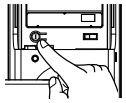

按 **I** [登记键]

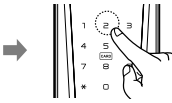

按 2

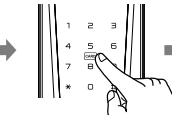

① 输入[管理者]密码
② 按 #



扫描要登记的指纹
(重复3次)

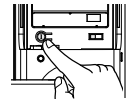

按 **I** [登记键]

6 登记指纹[保安模式]

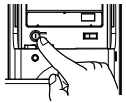

按 **I** [登记键]

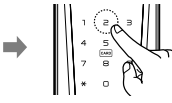

按 2

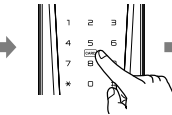

① 输入[管理者]密码
② 按 #
③ 要登记的
[指纹号码] (4位)



扫描要登记的指纹
(3次重复)

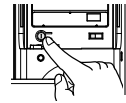

按 **I** [登记键]

7 登记卡钥匙 (YDM7111此产品为限定)

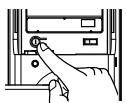

按 **I** [登记键]

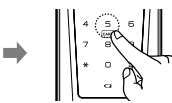

按 5

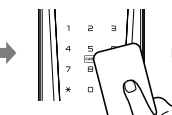

把要登记的卡钥匙依次接触到
[卡钥匙接触部]

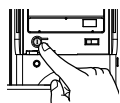

按 **I** [登记键]

▲ 注意

- * [使用者]密码：开启门锁时，使用的密码(6~12位)
- * [管理者]密码：指纹登记/删除时，使用的密码(6位)
- * 指纹号码：在[保安模式]状态下，必须指定的每个指纹的指纹号码(4位)
- * 本产品出厂时，默认设定为[一般模式]

快速使用指南

7 从外部锁定

为了确定锁定，
门关上后，必须向上抬起把手



用把手锁定
(向上旋转)

8 从门外开启门锁

(方法#1) 输入已登记的密码后触摸密码键, 向下旋转把手

(方法#2) 接触已登记的指纹后, 向下旋转把手



用把手开启门锁
(向下旋转)

9 从门内开启或关闭门锁

按住安全把手按钮的同时
旋转把手开启或关闭门锁



关闭门锁
(向上旋转)



开启门锁
(向下旋转)

10 紧急机械钥匙

由于以下原因无法开启或关闭门锁时，
请用紧急机械钥匙开启/关闭门锁

- 忘记[使用者]密码
- 电子系统不能正常工作

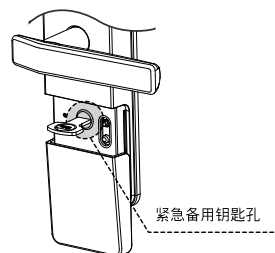

使用方法

使用指导	38
产品规格	
各部位名称	
使用产品	40
密码使用方法	
指纹使用方法	
一般模式下的使用方法	
保安模式下的使用方法	
删除指纹	
使用卡钥匙 (YDM7111此产品为限定)	
门锁定	
从内部开启	
设定功能	50
安全紧急快开功能·音量调节功能	
指纹模式变更/设定	
自动锁定功能·随通功能	
强制锁定功能	
声音和旋律·语言选择	
使用机械钥匙时, 警报设定/解除	
安心功能	56
警报功能	
3分钟自动锁死功能	
虚数密码功能	
紧急机械钥匙	
其他事项	
选购产品	58
网络盒	
遥控器	
常见问题及解决方法	60
电池耗尽情况下 / 从外部提供电源的方法	
申请维修方法	
产品规格明细	62

产品规格

基本构成品

为了提升产品功能和质量所作的内部结构的更改，恕不另行通知。

》 构成品

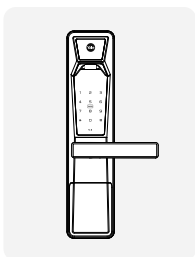

前壳(室外部)

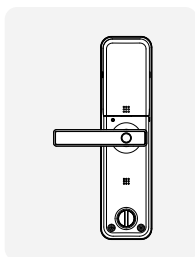

内壳(室内部)

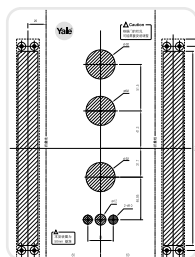

安装图

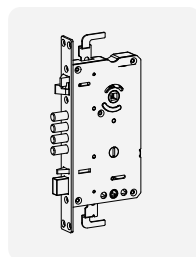

锁芯

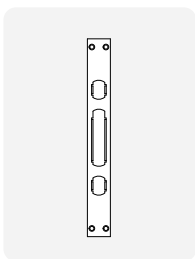

锁扣片



说明书

4个电池
 机械钥匙
 螺丝
 卡钥匙 (YDM7111此产品为限定)
 外锁连杆

》 选项产品

- 遥控器
- 网络盒

各部位名称

使用方法

前壳(室外部)

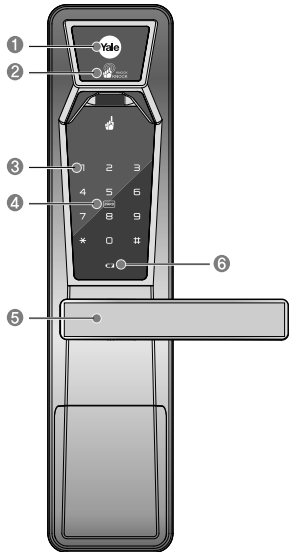

滑开紧急备用盖

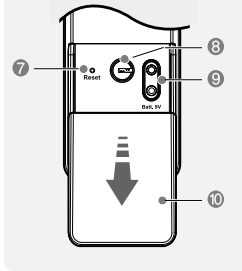

9V 紧急电池
(另购)

①	激活感应部
②	指纹感应部
③	智能密码键
④	卡钥匙接触部 (YDM7111此产品未限定)
⑤	把手(室外部)
⑥	电池更换警告灯
⑦	重新启动按键
⑧	机械钥匙锁芯
⑨	紧急电源接触口
⑩	紧急备用滑盖

内壳(室内部)

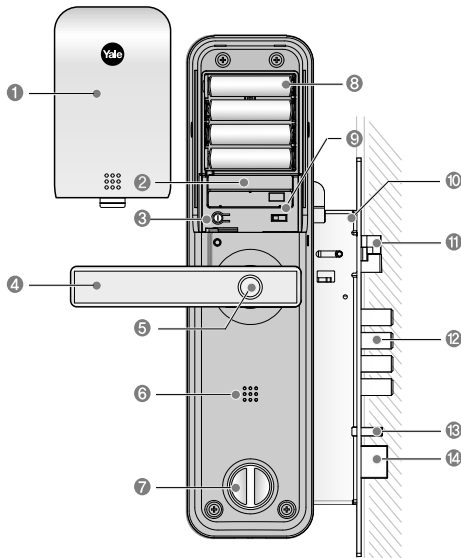

①	电池盖
②	网络盒插槽
③	① 登记按键
④	把手(室内部)
⑤	安全按钮
⑥	喇叭
⑦	内部强制锁定旋钮
⑧	1.5V AA 电池
⑨	音量调节按钮
⑩	锁芯
⑪	斜舌
⑫	锁舌(方舌)
⑬	锁栓
⑭	内部强制锁定锁舌

使用产品

[管理者] 密码的使用方法 新产品出厂时, [管理者] 密码默认设定为 1, 2, 3, 4, 5, 6

》 登记[管理者] 密码

顺序	操作	具体方法
1 按 ① [登记键]		滑开室内部的电池盖后, 按 ① [登记键]
2 按 1, 2		按照声音提示, 先按 1, 再按 2
3 输入已登记的 管理者密码		按照声音提示, 输入已登记的管理者密码 (6位) ※ 新产品出厂时, [管理者] 密码默认设定为 1, 2, 3, 4, 5, 6
4 按 #		按 #
5 输入要登记的 [管理者] 密码		按照声音提示, 输入要登记的新管理者密码 (6位)
6 按 ① [登记键]		再按 ① [登记键], 密码登记结束

使用管理者密码



指纹登记或删除时, 必须要管理者密码
忘管理者密码时, 不能登记或删除指纹

☞ 参考

新产品出厂时, [管理者] 密码默认设定为 1, 2, 3, 4, 5, 6
为了防止忘记 [管理者] 密码, 推荐设置成与 [使用者] 密码一致

使用产品

使用方法

[使用者] 密码的使用方法

密码设定时, 不能使用 * 和 # 键

》登记 [使用者] 密码 → ①, 1, 1, 密码(6~12位), ①

顺序	操作	具体方法
1 按 ① [登记键]		滑开室内部的电池盖后, 按 ① [登记键]
2 按 1, 1 → 输入密码		按照声音提示, 先按 1, 再按 1 后, 输入要登记的6~12位密码。
3 按 ① [登记键]		再按 ① [登记键], 密码登记结束

》用 [一般] 密码开启 , 密码(6~12位), 

顺序	操作	具体方法
1 用手掌触摸密码键		用手掌触摸密码键
2 输入已登记的密码		在室外部的触摸键, 输入已登记的密码(6~12位)
3 用手掌触摸密码键		用手掌触摸密码键或, 按 *

参考

- 登记密码或更改密码时, 把门开着操作, 以免失误的情况
- 每次密码变更时, 之前登记的密码自动删除
- 完成登记密码后, 密码键(智能密码键)显示确认完成的密码

使用产品

指纹使用方法

》 指纹使用指南

一般模式：可以登记个别指纹。用个别指纹或密码开启

保安模式：指纹号码和登记的指纹一致时，开启

连续动作

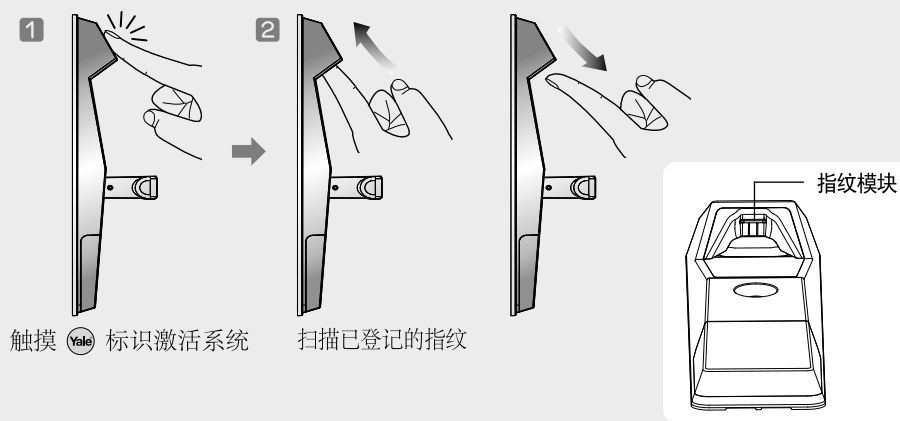

☞ 参考

- 可以登记20个指纹
- 本产品采用扫描式指纹模块。湿手或有异物时，不能识别指纹。
- 登记指纹或更改指纹时，把门开着操作，以免失误的情况
- 可以重复登记已登记的指纹

使用产品

在[一般模式]下使用方法 可以登记个别指纹。用个别指纹或密码开启

》登记指纹 → ①, 2, 管理者密码, #, 扫描指纹(3次), ①

顺序	操作	具体方法
1 按 ① [登记键]		滑开室内部的电池盖后, 按 ① [登记键]
2 按 2 → 管理者密码 → 按 #		按照声音提示, 先按 2 后, 输入已登记的管理者密码, 最后按 #
3 扫描指纹(3次)		按照声音提示, 扫描指纹3次
4 按 ① [登记键]		再按 ① [登记键], 登记结束 (如继续登记指纹, 按 #)

》用指纹开启

顺序	操作	具体方法
1 触摸  标识		触摸Yale标识激活系统
2 扫描指纹		扫描已登记的指纹

确认正常开启



登记密码或登记指纹后, 必须检查是否正常登记完成

使用产品

在[保安模式]下使用方法 指纹号码和登记的指纹一致时, 开启

》登记指纹 → ①, 2, 管理者密码, #, 指纹号码, 扫描指纹(3次), ①

顺序	操作	具体方法
1 按 ① [登记键]		滑开室内部的电池盖后, 按 ① [登记键]
2 按 2 → 管理者密码 → 按 #		按照声音提示, 先按 2 后, 输入已登记的管理者密码, 最后按 #
3 登记指纹号码		输入要登记的4位指纹号码 ※ 指纹号码: 4位
4 扫描指纹(3次)		按照声音提示, 扫描指纹3次
5 按 ① [登记键]		再按 ① [登记键], 登记结束 (如继续登记指纹, 按 #)

》用指纹开启 → , 指纹号码, 扫描指纹

顺序	具体方法
1 用手掌触摸密码键	 用手掌触摸密码键
2 输入指纹号码	 输入已登记的指纹号码(4位)
3 扫描指纹	 扫描已登记的指纹

使用产品

使用方法

删除指纹

在[保安模式]下, 只能删除个别指纹

» 删除全部指纹 → 按 ①, 3, 管理者密码, ①

顺序	操作	具体方法
1 按 ① [登记键]		滑开室内部的电池盖后, 按 ① [登记键]
2 按 3 → 管理者密码		按照声音提示, 先按 3 后, 输入已登记的管理者密码
3 按 ① [登记键]		再按 ① [登记键], 完成删除全部指纹

» 删除个别指纹(在[保安模式]) → 按 ①, 4, 管理者密码, #, 指纹号码, ①

顺序	操作	具体方法
1 按 ① [登记键]		滑开室内部的电池盖后, 按 ① [登记键]
2 按 4 → 管理者密码 → 按 #		按照声音提示, 先按 4 后, 输入已登记的管理者密码, 最后按 #
3 输入指纹号码		输入要删除的指纹号码
4 按 ① [登记键]		再按 ① [登记键], 完成删除个别指纹

使用产品

卡钥匙使用方法 (YDM7111此产品为限定)

》登记卡钥匙 (YDM7111此产品为限定)

顺序	操作	具体方法
1 按 ① [登记键]		打开室内部的电池盖后, 按 ① [登记键]
2 按 5		按照声音提示, 按 5
3 接触卡钥匙		把要登记的所有卡钥匙依次接触到[卡钥匙接触部].
4 按 ① [登记键]		再按 ① [登记键], 卡钥匙登记结束.

使用产品

使用方法

》用卡钥匙开（YDM7111此产品为限定）

顺序	操作	具体方法
接触已登记的卡钥匙		在室外部的[卡钥匙接触部]，接触已登记的卡钥匙。

确认是否正常登记



登记卡钥匙结束后，
必须再次确认是否正常开启。

参考

- 首先要登记密码，以免丢失卡钥匙时不能开门
- 每次重新登记卡钥匙时，已登记的卡钥匙自动失效。
- 最多可以登记40个卡钥匙。

使用产品

锁定门

》从外部锁定

顺序	操作	具体方法
室外部的把手向上旋转	 室外部	出门后，把室外部的把手向上旋转锁定。

※ 出门时，必须把室外部的把手向上旋转锁定。

》从内部锁定

顺序	操作	具体方法
室内部的把手向上旋转	 室内部	握住把手按钮，把室内部的把手向上旋转锁定。

▲ 注意

- 如果把手没有向上转到位，则不能锁定。请注意将把手旋转到锁定位置。

使用产品

使用方法

从内部开启

生产出厂时，初始状态是安全把手模式.

》在[安全把手模式]下，开启

按下室内部的把手安全钮，
转动把手开启

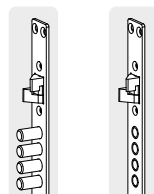
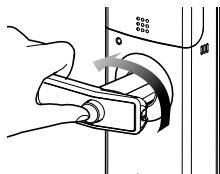

(锁定)

(开启)

》在解除[安全把手模式]下，开启

直接转动室内部的把手开启

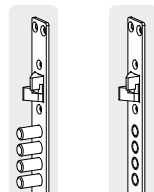
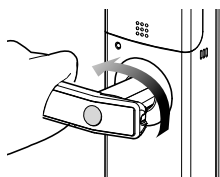

(锁定)

(开启)

参考

- 请确保熟练掌握安全把手的使用方法，以防紧急事件发生时，无法开启门锁。

设置方法

安全把手功能

》解除安全把手模式

- 1 滑开室内部的电池盖后，
拿出“L”型搬手
- 2 按着[安全快开按钮]，按顺时针方向，
转把手侧面的无头螺丝

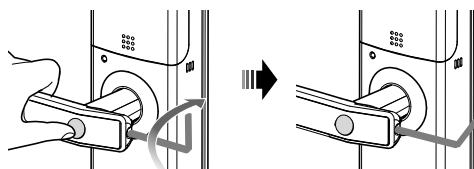

安全快开按钮

》设置安全把手模式

- 1 滑开室内部的电池盖后，
拿出“L”型搬手
- 2 按逆时针方向，转把手侧面的无头螺丝，
到凸出状态为止

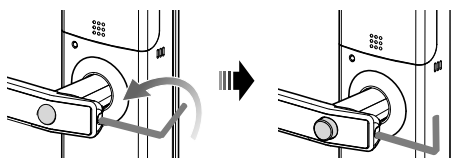

安全快开按钮 (凸出状态)

音量调节功能

控制产品的各种音量

》设定音量

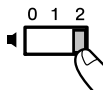
顺序	操作	具体方法
设定音量按钮		0: 无声音, 1: 小声音, 2: 大声音

☞ 参考

- 设定[安全紧急快开功能]时，注意无头螺丝不要完全脱离把手。
在无声音设定状态下，误动作警告音及警告音会发生。

设置方法

指纹模式变更/设定 出厂时，默认设定为[一般模式]状态

》 设置为[保安模式] / [一般模式]

顺序	操作	具体方法
1 按  指纹模式变更/设定 → 按 #	 #	滑开室内部的电池盖后，按  [登记键] → 再按室外部密码键的 #
保安模式 按 1, 1 → 输入管理者密码		先按 1, 1 后，输入已登记的管理者密码
一般模式 按 1, 3 → 输入管理者密码		先按 1, 3 后，输入已登记的管理者密码
2 按  [登记键]		再按  [登记键]，设定为[保安模式] / [一般模式]

参考

- 在设定[保安模式]下，登记指纹后，不能用密码开启
 (但指纹模块故障时，可以使用已登记的6~12位密码开启)

设置方法

自动锁定功能

自动锁定设置在关门后1分钟内锁定门锁。

》设置自动锁定模式 → 按 ①, #, 0, 1, ①

顺序	操作	具体方法
1 按 ① [登记键] → 按 #		滑开室内部的电池盖后, 按 ① [登记键] → 再按室外部密码键的 #
2 按 0, 1		按室外部密码键的 0 后 → 再按 1
3 按 ① [登记键]		再按 ① [登记键], 设定完成

随通功能

》设置随通模式 → 按 ①, #, 0, 3, ①

顺序	操作	具体方法
1 按 ① [登记键] → 按 #		滑开室内部的电池盖后, 按 ① [登记键] → 再按室外部密码键的 #
2 按 0, 3		按室外部密码键的 0 后 → 再按 3
3 按 ① [登记键]		再按 ① [登记键], 设定完成

参考

- 随通模式下, 你可以随时从任何方向通过旋转把手开启门锁。
- 闪烁的红灯表示把手处于随通模式下。
- 在随通模式下, 请确保是否门正常上锁。

设置方法

强制锁定功能

》外部强制锁定 - 用指纹



- ① 触摸 Yale 标识激活系统
- ② 扫描已登记的指纹
- ③ 按 # 键5秒后, 有 'BIK-BIK-BIK' 声音

》外部强制锁定 - 用密码



- ① 用手掌触摸密码键盘
- ② 在外部的密码按键盘, 输入已登记的密码.
- ③ 按 # 键5秒后, 有 'BIK-BIK-BIK' 声音

》外部强制锁定 - 用卡钥匙 (YDM7111此产品为限定)

顺序	操作	具体方法
接触卡钥匙5秒		把[卡钥匙]接触在[卡钥匙接触点]5秒 → 3次 "BIK" 的声音

》内部强制锁定设置

顺序	操作	具体方法
设置或取消内部强制锁定开关		当门锁关闭时, 打开内部强制锁定开关来锁定或取消当前状态

☞ 参考

- 一旦发出警报声, 解除警报之前, 警报会继续30分钟

设置方法

声音和旋律

(可以在开门和关门时, 选择操作的语音)

》设置声音和旋律的方法

顺序	操作	具体方法
1 按  [登记键] 按 #		滑开室内部的电池盖后, 按  [登记键] →再按室外部密码键#
2 按2, 2		按室外的密码键的2后, 再按2
3 按  [登记键]		再按  [登记键], 设定完成

语言选择

(中英文切换)

》设置语言

顺序	操作	具体方法
1 按  [登记键] 按 #		滑开室内部的电池盖后, 按  [登记键] →再按室外部密码键#
2 按2, 3		按室外的密码键的2后, 再按3
3 按  [登记键]		再按  [登记键], 设定完成

参考

- 设定警报时, 并每回可设定或解除.

设置方法

使用方法

使用机械钥匙时，警报设定/解除

》警报设定

顺序	操作	具体方法
1 按 ① [登记键]后， 按 #		滑开室内部的电池盖后，按 ① [登记键]， 再按 #
2 按 0 后，按 8		在室外部密码键，按 0 后，再按 8
3 按 ① [登记键]		按 ① [登记键]，设定完成

参考

- 设定警报时，并每回可设定或解除。

安心功能

警报功能

如没有解除警报状态，警报声音持续30分钟。

》 侵入/破损警报

侵入：从外部破坏门侵入时，
警报声音发生

破损：从外部破坏锁体时，
警报声音发生

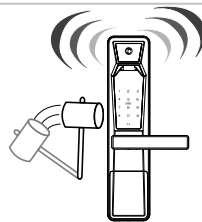

解除侵入/破损警报

方法①：输入已登记的密码

方法②：扫描已登记的指纹

方法③：按室内部的 ① [登记键]5秒

3分钟自动锁死功能

在[3分钟自动锁死]状态下，不能操作室外部的锁体。

》 3分钟自动锁死显示

指纹和密码连续进行5次错误操作，
本产品会自动停止3分钟。
智能密码键盘显示剩下的时间

解除[3分钟自动锁死]

方法①：按时内部的 ① [登记键]

方法②：转室内部的把手，开启。

方法③：用机械钥匙，开启

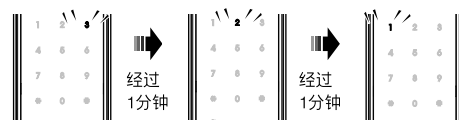

3分钟自动锁死状态

3 → 剩余3分钟

2 → 剩余2分钟

1 → 剩余1分钟

参考

- 在损坏报警状态下，键盘上的数字会顺时针方向自动亮灯
(这种状态会持续和报警音一起保持30分钟)
- 3分钟锁定不会影响报警状态，而且重启后会继续保持这种状态。

安心功能

使用方法

虚数密码功能

害怕密码被盗时，加虚数密码防止密码泄露。

》用虚数密码开启

顺序	操作	具体方法
1	用手掌触摸密码键	用手掌触摸密码键
2	输入虚数密码和已登记的密码	方法①：虚数密码 → 已登记的密码 方法②：已登记的密码 → 虚数密码
3	用手掌触摸密码键	用手掌触摸密码键或，按 *

紧急机械钥匙使用方法

》紧急机械钥匙使用方法

如出现忘记密码，电池电量耗尽或电子系统异常无法运作等紧急情况时用紧急备用钥匙可锁门或开门
将室外部的紧急备用滑盖往下推，可看到紧急备用钥匙孔
对准紧急备用钥匙孔，插入钥匙并旋转可锁门或开门

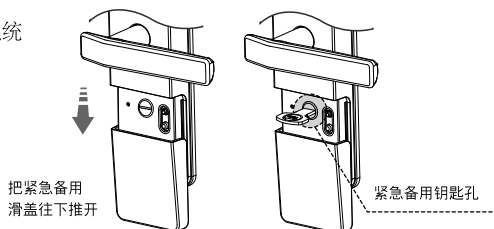

▲ 注意

警报设定状态下，使用机械钥匙时会发生警报音
在内部强制锁定状态下，使用机械钥匙不能开启。

📖 参考

- 当3分钟锁定模式开启时，虚数密码功能将不能工作直到下一个正常模式被确认（卡，密码，从门内开启）。在这种情况下，请使用正确密码开启门锁。
- 妥善保管机械钥匙。
- 请保管好品质保证书，否则，在保证期内无法获得免费售后服务。

选购产品

网络盒

本产品通过简单的设置，可使用多种功能。功能升级之前先确认目前正在使用产品的型号。

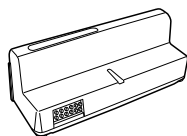

网络盒

》安装[网络盒]

1 拆下电池

打开室内部的电池盖，
拆下所有的电池。

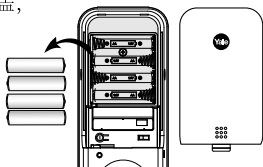

2 安装网络盒

把网络盒安装在网络盒插口。

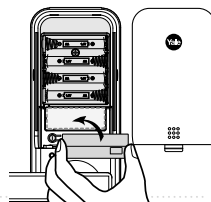

3 安装电池

确认(+), (-)方向，
再放入全部电池。

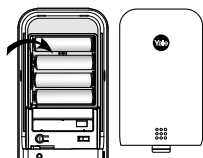

4 确认

“DI-RI-RI-RING”声音时，
正常安装完成。

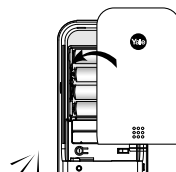

DI-RI-RI-RING

选购产品

其他事项

遥控器

》登记遥控器 → ①, #, 0, 5, 遥控器登记键(SET), ①

顺序	操作	具体方法
1 按 ① [登记键] → 按 #		滑开室内部的电池盖后, 按 ① [登记键] → 再按室外部密码键的 #
2 按 0, 5		按室外部密码键的 0, 5
3 按遥控器的登记键		用针按一下遥控器的[SET/登记按钮] (可以连续登记到5个遥控器)
4 按 ① [登记键]		再按 ① [登记键], 登记完成

》删除遥控器 → ①, #, 7, 5, ①

顺序	操作	具体方法
1 按 ① [登记键] → 按 #		滑开室内部的电池盖后, 按 ① [登记键] → 再按室外部密码键的 #
2 按 7, 5		按室外部密码键的 7, 5
3 按 ① [登记键]		再按 ① [登记键], 删除完成

常见问题及解决方法

电池耗尽情况下，从外部提供电源的方法

》 从外部提供电源的方法

顺序	操作	具体方法
1 接上9V电池		把[紧急备用滑盖]往下推开后，接上9V电池。
2 用手掌触摸密码键盘		用手掌触摸密码键盘
3 输入密码		输入已登记的密码
4 按 *		再按 *，正常开启后，电池解开。

》 电池更换方法

1 电池使用寿命

本产品使用4节1.5V 碱性 AA型号电池。
每天使用10次为标准可使用1年。(正品碱性电池)



2 更换电池提示

使用本产品时，如有随着提示音
或电池更换警告灯闪烁提示，请更换全部电池

更换电池提示灯(红灯)

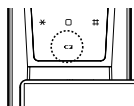

室外部



参考

按电池使用的环境(温度、湿度、使用量)和电池品质，电池寿命期会有不一样

常见问题及解决方法

申请维修方法

产品出现异常时，请与安装点(销售点)联系。

产品保修期间可以无偿享受A/S。

但是因消费者使用不当出现A/S或超过保修期，被认定为有偿A/S。

■ 消费者维修类型

(产品保修期为购买之日起一年)

消费者维修标准		维修内容	
		保修期以内	保修期以后
正常使用状态下	购买安装后，12个月以内出现故障时	免费修理	有偿修理
	出现同样的故障2次时	免费修理	有偿修理
	出现同样的故障3次时	更换产品	有偿修理
	无修理用部件时	更换产品	有偿修理
非正常使用状态下	消费者失误造成的损坏	有偿修理	有偿修理
	电池等消耗品的更换	有偿修理	有偿修理
	产品原使用目的外的使用引起的的故障及损坏	有偿修理	有偿修理
	故意或消费者自行拆装等原因引起的故障及损坏	有偿修理	有偿修理
	丢失密码时的拆装	有偿修理	有偿修理
因意外灾害 (如火灾，水灾，煤气事故等所出现的故障)		有偿修理	有偿修理

没有或遗失产品保修卡时被认定为有偿A/S，所以请务必保管好产品保修卡及发票。

▲ 注意

没有或丢失产品保修卡时被认定为有偿A/S，所以请务必保管好产品保修卡及发票。

客户中心



400-880-7858

公司网站



www.yaledigital.com.cn
www.irevo.com.cn

产品规格明细

产品规格

构成物	产品式样	备注
室外部	76,6(W) × 334,6(H) × 28(D) mm, 锌压铸件	正规电压 : DC 6V 动作温度 : -15~55℃ 感应动作温度 : 55℃
室内部	76,6(W) × 304,6(H) × 35(D) mm, 阻燃ABS, 铝压铸件	
把手	锌压铸件	
干电池	1.5V 干电池 4节	一天10次使用标准 可使用一年
锁芯外壳	钢及SUS304不锈钢	
选择	遥控器	无线
		选择(另购)

使用期限根据干电池寿命可能有所差异

产品保修卡

S/N	购买日期	型号
客户姓名	地址	
电话号码 (H.P)	安装日期	
销售点	安装人员姓名	电话号码 (H.P)

※没有A/S产品保修卡时,被认定为有偿维修服务,所以请保管好此卡。

※公司联系号码

iRevo Inc.

上海易保电子有限公司

中国上海市闵行区先锋街25号宝纳大厦9楼E, F室 (邮编 : 201103)

电话 : (021) 6446-4067 传真 : (021) 6406-0521



客户中心

400-880-7858

其他事项

